

PROGRAM

**EIGHTIETH
ANNUAL MEETING
OF THE
AMERICAN
ASSOCIATION
OF
NEUROPATHOLOGISTS**

**JUNE 24 - 27, 2004
Renaissance Cleveland Hotel
Cleveland, Ohio**

GENERAL INFORMATION

Hotel: Renaissance Cleveland Hotel
 24 Public Square Cleveland, OH 44113
 Phone: 216-696-5600
 Fax: 216-696-0432

ALL MEETING SESSIONS WILL BE HELD IN THE RENAISSANCE CLEVELAND HOTEL.

PRE-REGISTRATION PICK-UP

Attendees pre-registered and pre-paid for the Special Course and/or Meeting will have their name badge, course syllabus, program booklets, reception ticket(s) and registration receipt ready for pick-up at the AANP Registration Desk, located at the main coat room on the lobby level of the hotel.. On-site registration, tickets to the Annual Reception, and additional copies of the May 2004 JNEN will be available at the Desk.

REGISTRATION

Location	Registration Desk	Main Coat Room
Time	Wednesday, June 23	6:00 pm - 9:00 pm
	Thursday, June 25	6:30 am - 12 noon 6:30 pm - 9:00 pm
	Friday, June 26	7:00 am - 12 noon 5:30 pm - 6:00 pm
	Saturday, June 27	7:00 am - 12 noon

PLEASE, wear your name badge!

Your name badge is *required for admittance* to any function of the Association, including the Special Course, all Friday, Saturday and Sunday sessions, and the Friday evening reception.

PROGRAM and SCIENTIFIC SESSIONS

SPECIAL COURSE: *Advances in the Diagnosis and Biology of Brain Tumors*

Joseph Parisi, MD and Scott Vandenberg, MD, PhD

Location	Grand Ballroom	
Time	Thursday, June 24	8:00 am - 5:30 pm

PLATFORM PRESENTATIONS

Location	Grand Ballroom A or B	
Time	Friday, June 25	8:00 am – 5:00 pm
	Saturday, June 26	8:30 am - 3:30 pm

POSTER PRESENTATIONS

Location	Exhibit Hall	
Time	Friday, June 25	8:00 am - 5:00 pm
	Saturday, June 26	8:30 am - 5:00 pm

SPECIAL LECTURE: *The autism tissue program and the state of the art in autism research*

Eric London, MD and Jane Pickett, PhD

Location	Grand Ballroom	
Time	Friday, June 25, 4:30-5:30 pm	

SPECIAL LECTURE: *Neuropathology of Musicians, Part II***Lucy B. Rorke, MD**

Location	Grand Ballroom
Time	Saturday, June 26, 5:30-6:00 pm

SAUL R. KOREY LECTURE: *The Road Not Taken***James M. Powers, MD**

Location	Grand Ballroom
Time	Saturday, June 26, 10:45-11:45 am

DIAGNOSTIC SLIDE SESSION

Location	Grand Ballroom
Time	Saturday, June 26, 8:00-11:00 pm

PRESIDENTIAL SYMPOSIUM: *Trinucleotide Repeat Disorders*

Location	Grand Ballroom
Time	Sunday, June 27, 8:00 am - 12 noon

NOTES to PRESENTERS**Platform Presenters (PowerPoint and 35mm slide)**

All platform presentations will be held in either the **Grand Ballroom A or B on the Mezzanine Level**. All general sessions (Special Lecture, Korey Lecture, Business Meetings, Diagnostic Slide Session, and Presidential Symposium) will be held in the . Grand Ballroom

Presenters should use PowerPoint for their presentation. If a 35mm slide projector is required, the presenter should contact the Program Chair prior to the meeting. All PowerPoint presentations will be transferred onto a show computer prior to the start time of each session. Each room will be equipped with a lectern, audience microphones, central computer (loaded with MS Office XP), LCD/Data projector, screens and a laser pointer.

Special Notes for PowerPoint presenters:

- Each speaker must bring his/her PowerPoint presentation on a disc (CD-ROM, 100 MB Zip disc, or 3 1/2" floppy disc) or USB memory stick.
- Please title the presentation with your name (name.ppt).
- Macintosh users, be sure to save your presentation as .ppt (*your name.ppt*). If the ".ppt" extension is not present in the file name, the file will not be recognized by the PC computer.
- Label your disc with your name, session name, time, and day of presentation. Your presentation will be transferred onto the show computer for each session by the technician. Please make sure your presentation is in its final form, since once loaded onto the show computer, no changes can be made.

Notes to PowerPoint presenters (continued)

- Please take your disc or memory stick to the room in which you will be presenting, the Grand Ballroom A or B at the times indicated below. **It is your responsibility to get your file to the AV staff prior to your presentation.**
- The AV staff will be available to load your file onto the computer during scheduled evening and morning times. **These will be the *only* times available to you to load and test your presentation.**

Schedule for Loading PowerPoint Presentations

Load show computer in The Grand Ballroom	
Wednesday June 23	5:30 - 6:30 pm
Thursday June 24	6:45 - 7:45 am 5:30 - 6:30 pm
Friday June 25	6:45 - 7:45 am 6:00 - 7:00 pm
Saturday, June 26	7:15 - 8:15 am 6:30 - 7:45 pm
Sunday June 27	6:45 - 7:45 am

- **If you are presenting in a morning session, it is preferable to check in the previous day.** Same-day presentations may be loaded in the morning prior to session start time, but since this time necessarily is limited, you are encouraged to have your presentation loaded on the evening preceding your talk. Presenters at the evening Diagnostic Slide Session also will be able to submit their files on Saturday evening from 6:30-7:45 pm.
- To avoid time delays and potential problems with your presentation, you will **not** be allowed to use your own computer, although you may bring your laptop as a backup.

Notes to Poster Presenters

All poster sessions will be held in the **Exhibit Hall**. Posters will be displayed during the entire Scientific Program, all day Friday and Saturday. Posters should be up by 8:00 am Friday and down by 5:30 pm Saturday.

To encourage interaction with interested attendees, authors are asked to be present at their posters for discussion/questions during morning or afternoon refreshment breaks, at the following designated times:

	Fri June 25	Sat June 26
	<i>Authors Present at:</i>	<i>Authors Present at:</i>
EVEN Numbered Poster	10:00 - 10:30 am	3:00 - 3:30 pm
ODD Numbered Poster	4:00 - 4:30 pm	10:15 - 10:45 am

SPEAKER READY ROOM

Electronic preview equipment will be available in the Brush Room on the Conference Level

Location	Brush Room	
Time	Wednesday, June 23	7:00 pm - 9:00 pm
	Thursday, June 24	7:00 am - 5:30 pm
	Friday, June 25	7:00 am - 5:30 pm
	Saturday June 26	7:00 am - 5:30 pm

MICROSCOPE VIEWING ROOM

Multi-headed microscopes will be available in the *George Bush Room located on the Mezzanine Level.*

Location	George Bush Room	
Time	Thursday, June 24	7:00 am - 5:30 pm
	Friday, June 25	7:00 am - 5:30 pm
	Saturday June 26	7:00 am - 5:30 pm

ABSTRACTS

Abstracts of the papers presented in the program are published in the May 2004 issue of the *Journal of Neuropathology and Experimental Neurology*. Separate abstract books are not printed. Members should take their copy of the JNEN to the meeting. Non-member registrants will receive a copy at registration. A limited number of copies of the JNEN will be available for purchase at the Registration Desk for \$5 each.

BUSINESS MEETING

Location	Grand Ballroom A	
Time	Friday, June 25	12:00 - 12:45 pm
	Saturday June 26	11:45 - 12:45 pm

The Meritorious Service Award will be presented on Saturday, June 26.

ANNUAL RECEPTION

The annual reception will be held 6:30 to 8:30 pm. Friday in the Ambassador Reception Hall on the lobby level of the hotel. Registrants and guests of the American Association of Neuropathologists are welcome to attend. A cash bar will be available and hors d'oeuvres will be served. Additional tickets are \$20 each for non-trainees and \$10 each for residents/fellows/students, and may be purchased at the registration desk or at the door. Several "prizes" will be awarded at the festivities.

Location	Ambassador Reception Hall	
Time	Friday, June 25 6:30 pm to 8:30 pm	

SPECIAL MEETINGS

Date	Meeting	Time/Location
Wed June 23	Alzheimer Disease Center Neuropathology Core Leaders	6:00 pm Ambassador Reception Hall
Thurs June 24	Executive Council	6:00 pm Van Aken
	Awards Committee	5:30 – 6:30 pm Carnegie Board Room
Fri June 25	Awards Committee	5:30 – 6:30 pm Carnegie Board Room
Sat June 26	Awards Committee	6:00 – 8:00 pm Van Aken
	Professional Affairs	6:00 – 8:00 pm Blossom

CME Credit

The American Association of Neuropathologists is accredited by the Accreditation Council for Continuing Medical Education (ACCME) to sponsor continuing medical education for physicians. The annual meeting is approved for credit under Category 1 of the Physician's Recognition Award of the American Medical Association on an hour-to-hour basis of attendance.

The AANP certifies the *Special Course* as a continuing medical education activity and meets the criteria for 8 credit hours in Category 1 of the Physician's Recognition Award of the American Medical Association. Further, the AANP certifies the *Scientific Sessions*, the *Korey Lecture*, the *Diagnostic Slide Session* and the *Presidential Symposium* as continuing medical education activities that meet the criteria for 15, 1, 3, and 3 credit hours, respectively, in Category 1 of the Physician's Recognition Award of the American Medical Association.

Activity	CME Credit Hours
Special Course	8
Scientific Sessions	15
Korey Lecture	1
Dx Slide Session	3
Presidential Symposium	3
Total	30

Attendees should claim credit only for those activities attended. Please be certain to complete and sign the official record of attendance form included with your registration materials.

DISCLOSURE/CONFLICT OF INTEREST

Disclosures (if any) from **all** platform and poster presenters for this year have been published along with the abstracts in the May issue of JNEN.

SPONSORS and DONORS

This meeting is sponsored in part by generous contributions from several sponsors and donors. Please visit their displays and exhibits in the Exhibit Hall.

Location	Exhibit Hall	
Time	Wednesday, June 23	7:00 pm - 9:00 pm
	Thursday, June 24	7:00 am – 5:30 pm
	Friday, June 25	7:00 am – 5:30 pm
	Saturday June 26	7:00 am – 5:30 pm

MEETING SPONSORS

TO BE ANNOUNCED

RECEPTION PRIZE CONTRIBUTORS

LOBBY LEVEL (SECOND FLOOR)

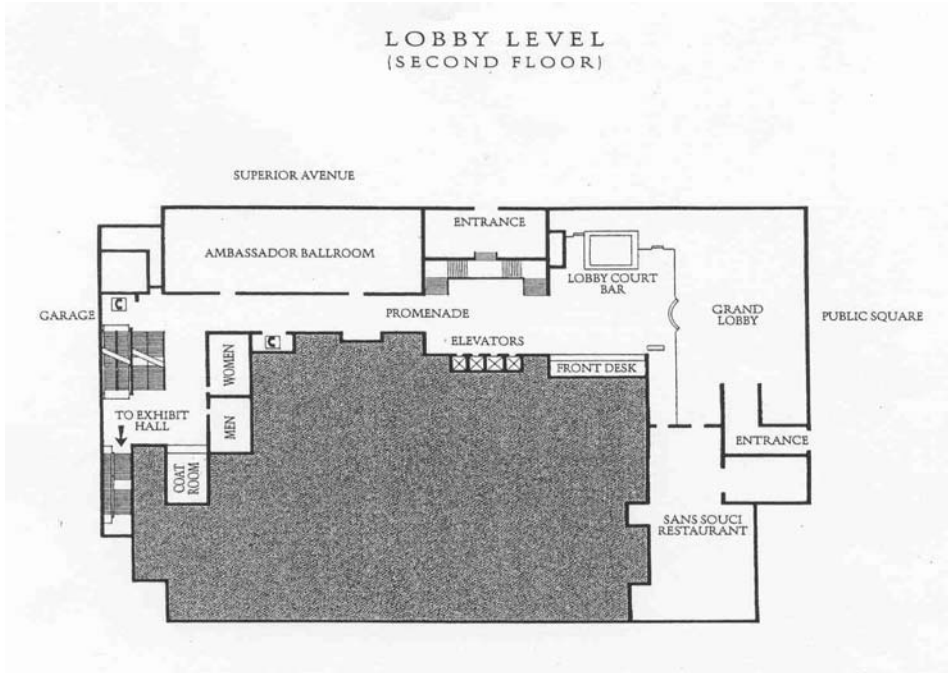

CONFERENCE LEVEL (FOURTH FLOOR)

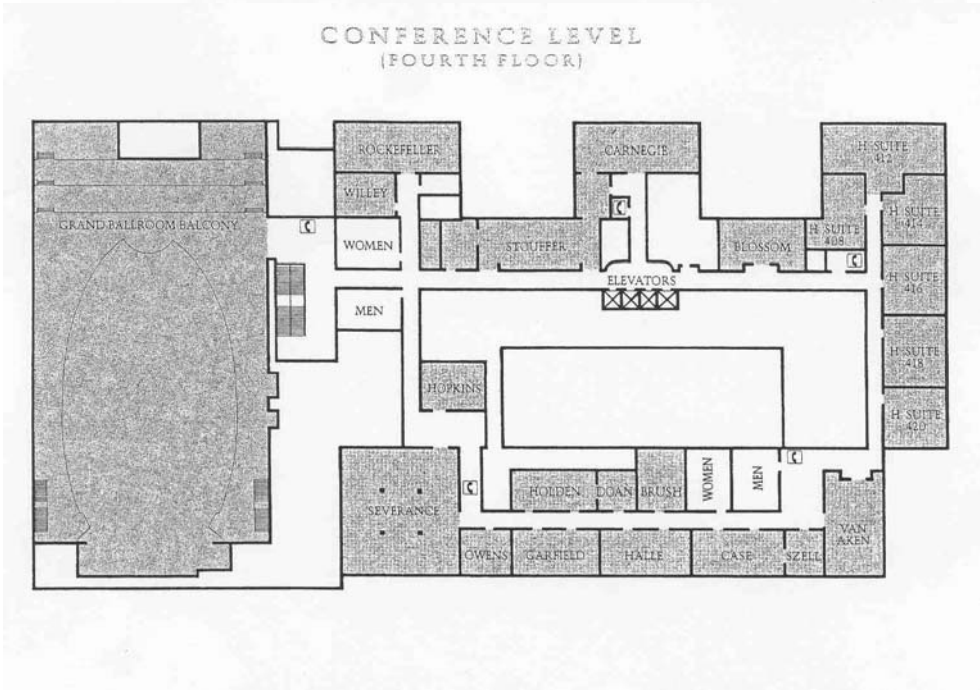

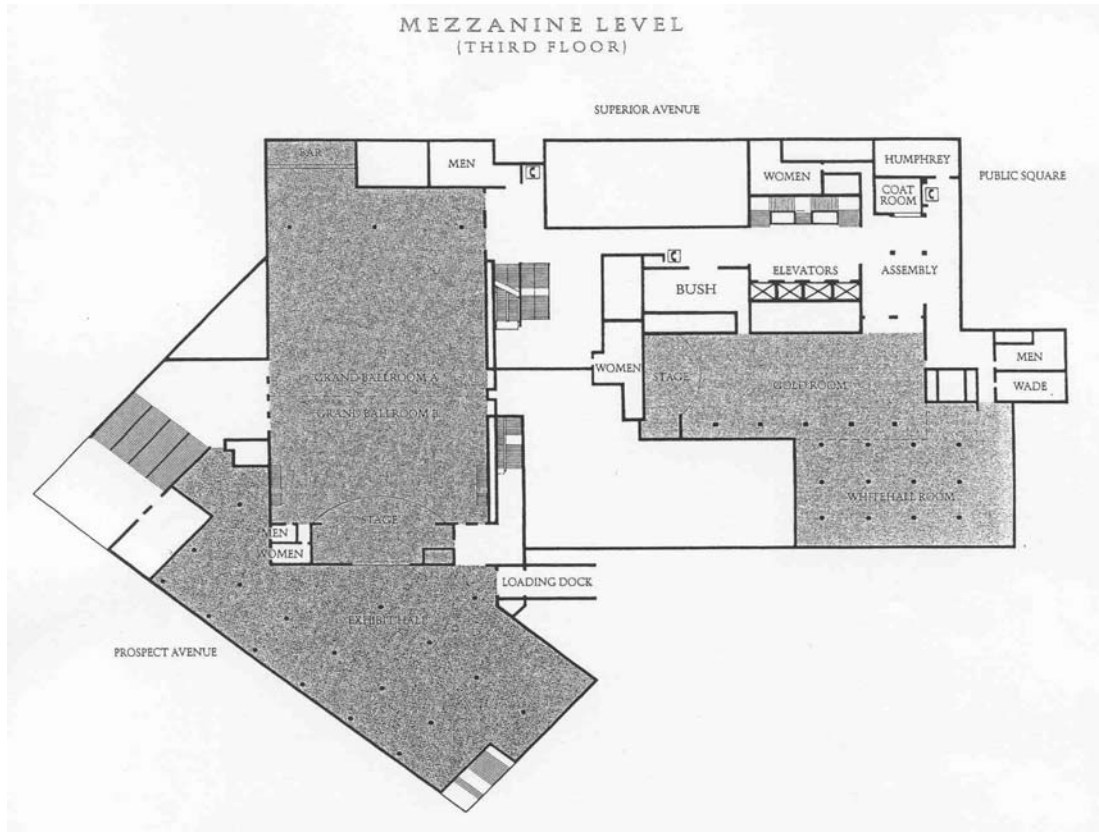

MEETING AT A GLANCE (Abstract Numbers in Italics)

FRIDAY June 25, 2004			
	Grand Ballroom A	Grand Ballroom B	Exhibit Hall
8:00 - 10:00 am	Platform 1 Demyelination/ Neurobiology/ Vascular: <i>#1 - 7</i>	Platform 2 Glial Tumors I: Cell Biology/ Expression Profiling <i>#8 - 15</i>	All Posters 7: Alzheimer/Aging <i>#44 - 56</i> 8: Degen Non-AD <i>#57 - 72</i>
10:00 - 10:30 am	REFRESHMENT BREAK		9: Dev/Pediatric <i>#73 - 80</i>
10:30 - 12:00 pm	Platform 3 Degenerative I: Prion Disease <i>#16 - 21</i>	Platform 4 Peripheral Nerve/ Muscle <i>#22 - 27</i>	10: Infectious Dis <i>#81 - 83</i> 11: Methods <i>#84 - 85</i>
12:10 - 12:50 pm	BUSINESS MEETING I Grand Ballroom A		12: Nerve/ Muscle <i>#86 - 93</i>
12:50k - 2:00 pm	LUNCH		13: Tox/ Metabolic <i>#94 - 97</i>
	Grand Ballroom A	Grand Ballroom B	14: Trauma <i>#98 - 99</i>
2:00 - 4:00 pm	Platform 5 Non-glial Tumors: <i>#28 - 35</i>	Platform 6 Development/ Pediatrics/ Genetics <i>#36 - 43</i>	15: Glial Tumors <i>#100 - 122</i> 16: NG Tumors <i>#123 - 150</i>
4:00 - 4:30 pm	REFRESHMENT BREAK		

4:30 - 5:30 pm	SPECIAL LECTURE The autism tissue program and the state of the art in autism research. <i>Eric London, MD and Jane Pickett, PhD</i>	17: Vascular <i>#151 - 154</i>
-------------------	-----------------------------------------------------------------------------------------------------------------------------------------------------	-----------------------------------

**6:30 - 8:30 pm ANNUAL RECEPTION: Ambassador Reception Hall
MEETING AT A GLANCE (Abstract Numbers in Italics)**

SATURDAY June 26, 2004			
	Grand Ballroom A	Grand Ballroom B	Exhibit Hall
8:30 - 10:15 am	Platform 18 Degenerative II: Neuropathology <i>#155 - 160</i>	Platform 19 Glial Tumors II: Biomarkers <i>#161 - 167</i>	All Posters 7: Alzheimer/Aging <i>#44 - 56</i> 8: Degen Non-AD <i>#57 - 72</i>
10:15 - 10:45 am	REFRESHMENT BREAK		9: Dev/Pediatric <i>#73 - 80</i>
10:45 - 11:45 am	SAUL R. KOREY LECTURE The Road Not Taken <i>James M. Powers, MD</i>		10: Infectious Dis <i>#81 - 83</i>
11:45 - 12:45 pm	BUSINESS MEETING II Grand Ballroom A		11: Methods <i>#84 - 85</i>
12:45 - 1:45 pm	LUNCH		12: Nerve/ Muscle <i>#86 - 93</i>
	Grand Ballroom A	Grand Ballroom B	13: Tox/ Metabolic <i>#94 - 97</i>
1:45 - 3:00 pm	Platform 20 Degenerative III: Biochemical <i>#168 - 172</i>	Platform 21 Infectious Disease <i>#173 - 176</i>	14: Trauma <i>#98 - 99</i> 15: Glial Tumors <i>#100 - 122</i>
3:00 - 3:30 pm	REFRESHMENT BREAK		16: NG Tumors <i>#123 - 150</i>
3:30 - 5:15 pm	Platform 22 Degenerative IV: Model Systems <i>#177 - 181</i>	Platform 23 Development/ Pediatric II: <i>#182 - 188</i>	17: Vascular <i>#151 - 154</i>
5:30 - 6:00 pm	SPECIAL LECTURE Neuropathology of Musicians, Part II <i>Lucy Rorke, MD</i>		Grand Ballroom A
8:00- 11:00 pm	DIAGNOSTIC SLIDE SESSION		Grand Ballroom

THURSDAY, June 24, 2004
SPECIAL COURSE
ADVANCES IN THE
DIAGNOSIS AND BIOLOGY OF BRAIN TUMORS

Directors: *Joseph E. Parisi and Scott R. Vandenberg*
Grand Ballroom

8:00 - 8:15	Introduction Joseph E. Parisi, MD <i>Mayo Clinic, Rochester, MN</i> Scott R. Vandenberg, MD, PhD <i>UCSF Medical Center, San Francisco, CA</i>
8:15 - 9:00	Genetic and Epigenetic Events in the Development of Tumors of Astrocytic Lineage Paul H. Kleihues, MD <i>University Hospital, Zurich, Switzerland</i>
9:00 - 9:45	Oligodendrogliomas: Histological, and Molecular Definitions David N. Louis, MD <i>Massachusetts General Hospital, Boston, MA</i>
9:45 - 10:15	REFRESHMENT BREAK
10:15 - 11:00	Medulloblastomas and ATRT Charles G. Eberhart, MD, PhD <i>John Hopkins University, Baltimore MD</i>
11:00 - 11:45	Meningiomas: Current Classification and Molecular Features Arie Perry, MD <i>Washington University, St. Louis, MO</i>
11:45 - 1:15	LUNCH
1:15 - 2:00	New Techniques: Genomics as Applied to the Study of Brain Tumors Gregory N. Fuller, MD, PhD <i>University Texas MD Anderson Cancer Center, Houston, TX</i>
2:00 - 2:45	Model Systems: Animal Models Eric C. Holland, MD, PhD <i>Memorial Sloan Kettering Cancer Center, New York, NY</i>
2:45 - 3:30	P13 Kinase Pathway Signaling Variants in High Grade Gliomas Paul S. Mischel, MD <i>UCLA Medical Center, Los Angeles, CA</i>
3:30 - 4:00	REFRESHMENT BREAK
4:00 - 4:45	Pathogenesis: Hypoxia, Angiogenesis and Glial Invasiveness Daniel J. Brat, MD, PhD <i>Emory University School Medicine, Atlanta, GA</i>
4:45 - 5:30	Brain Tumor Therapy Based on Molecular Pathogenesis Darell D. Bigner, MD, PhD <i>Duke University Medical Center, Durham, NC</i>

SUNDAY, JUNE 27, 2004
PRESIDENTIAL SYMPOSIUM ADVANCES IN THE DIAGNOSIS AND BIOLOGY OF
TRINUCLEOTIDE REPEAT DISORDERS

Grand Ballroom

8:00 - 8:05 am	Introduction Joseph E. Parisi, MD <i>Mayo Clinic, Rochester, MN</i>
8:05 - 8:55 am	Pathogenesis of Huntington's Disease Cynthia T. McMurray, PhD <i>Mayo Clinic, Rochester, MN</i>
8:55 - 9:45	Hereditary Ataxia and Trinucleotide Repeats Arnuf H. Koeppe, MD <i>VA Medical Center, Albany, NY</i>
9:45 - 10:15	AWARDS CEREMONY REFRESHMENT BREAK
10:15 - 11:05	Matthew T. Moore Distinguished Lecture: Toward Understanding the Pathogenesis of Repeat Expansion Diseases Henry L. Paulson, MD PhD <i>University Iowa Hospitals & Clinics, Iowa City, IA</i>

11:05 - 11:45	<i>Presidential Address: Neuropathology in the 21st Century: Challenges and Opportunities</i> Joseph E. Parisi, MD <i>Mayo Clinic, Rochester, MN</i>
11:45 - 12:00	<i>INSTALLATION OF NEW OFFICERS</i>
12:00 pm	<i>ADJOURNMENT</i>

FRIDAY, JUNE 25, 2004
Grand Ballroom A
8:00 am – 10:00

Platform 1: Demyelination/Neurobiology/Vascular
Chairpersons: Ray Sobel, Matt Frosch

8:00- 8:15	1	THE HISTONE DEACETYLASE INHIBITOR TRICHOSTATIN A AMELIORATES MURINE EXPERIMENTAL AUTOIMMUNE ENCEPHALOMYELITIS, A MODEL OF MULTIPLE SCLEROSIS Sandra Camelo, Antonio H Iglesias, Daehee Hwang, Brice Due, Steven G Gray Jaime Imitola, German Duran, Brett Langley, Matthew P Frosch, Samia J Khoury, George Stephanopoulos, Rajiv R Ratan, Umberta De Girolami, Robert J Ferrante, Fernando Dangond
8:15- 8:30	2	PATHOLOGIC CORRELATIONS OF MRI "DIRTY-APPEARING WHITE MATTER" IN MULTIPLE SCLEROSIS G R Wayne Moore, Cornelia Laule, Alex L MacKay, Esther Leung, David K B Li, Guojun Zhao, Anthony Traboulsee, Donald W Paty
8:30- 8:45	3	EPHRIN A RECEPTORS (Eph) AND LIGANDS (eph) IN LESIONS AND NORMAL-APPEARING WHITE MATTER (NAWM) IN MULTIPLE SCLEROSIS (MS) Raymond A. Sobel, Julie Kieu, James W. Brush, Whitney Campbell, Mary Jane Eaton, Julian R. Hinojoza
8:45- 9:00	4	PROTEOMIC ANALYSIS OF CEREBROSPINAL FLUID DISCRIMINATES MALIGNANT AND NON-MALIGNANT CNS DISEASE AND IDENTIFIES SPECIFIC PROTEIN MARKERS Daniel J Brat, John David L Nolen, Melinda Lewis, Savvas E Mendrinou
9:00- 9:15	5	OPPOSING ROLES OF ERK AND P38 MAP KINASES IN FGF2-INDUCED ASTROGLIAL PROCESS EXTENSION James W Mandell, Daniel S Heffron

FRIDAY, JUNE 25, 2004
Grand Ballroom A
8:00 am – 10:00 am

Platform 1 (continued): Demyelination/Neurobiology/Vascular
Chairpersons: Ray Sobel, Matt Frosch

9:15- 9:30	6	PROGRESSION OF CEREBRAL AMYLOID ANGIOPATHY IN SUPERFICIAL VESSELS DEMONSTRATED BY WHOLE BRAIN MULTIPHOTON IMAGING M P Frosch, E M Robbins, S B Domnitz, G W Rebeck, S M Greenberg, B J Bacskai
9:30- 9:45	7	A NEW CUTANEOUS MICROANGIOPATHY ASSOCIATED WITH CEREBROVASCULAR PATHOLOGY: RELATIONSHIP WITH HYPERHOMOCYSTEINEMIA Marie-Magdeleine Ruchoux, Marc Bataillard

10:00 – 10:30 am REFRESHMENT BREAK
FRIDAY, June 25, 2004
Grand Ballroom B
8:00 am – 10:00 a.m.

Platform 2: Glial Tumors 1: Cell Biology/Expression Profiling
Chairpersons: Dan Brat, David Zagzag

8:00-8:15	8	EXPRESSION OF OLIGODENDROGLIAL-SPECIFIC TRANSCRIPTIONAL FACTOR SOX10 DEFINES A DUAL NATURE OF HUMAN GLIOMAS Serguei I Bannykh, Jung Kim, Petra Lommes, Michael Wegner, Arie Perry
8:15-8:30	9	GLIOBLASTOMAS SHOW FREQUENT HYPERMETHYLATION AND TRANSCRIPTIONAL DOWN-REGULATION OF THE CTMP GENE ENCODING A NEGATIVE REGULATOR OF AKT Guido Reifenberger, Christiane Knobbe, Britta Blaschke, Julia Reifenberger
8:30-8:45	10	POPULATION-BASED STUDY ON THE INCIDENCE, SURVIVAL RATES, AND GENETIC PROFILE OF GLIOBLASTOMAS Hiroko Ohgaki, Pierre Dessen, Benjamin Jourde, Sonja Horstmann, Tomofumi Nishikawa, Christoph Burckhard, Pier-Luigi Di Patre, Paul Kleihues
8:45-9:00	11	DNA MICROARRAY ANALYSIS OF EPENDYMOMAS IDENTIFIED A SET OF PROGNOSTICALLY RELEVANT GENES Andrey Korshunov, Kai Neben, Axel Benner, Gunnar Wrobel, Meinhard Hahn, Peter Lichter
9:00-9:15	12	EXPRESSION OF ENZYMES AND RECEPTORS OF THE LEUKOTRIENE CASCADE IN ASTROCYTOMAS Mladen Golubic, Narendra Nathoo, Richard A Prayson, Judy V Bondar, Linda Vargo, Susana Arrigain, Edward J Mascha, John Suh, Gene H Barnett

FRIDAY, JUNE 25, 2004
Grand Ballroom B
8:00 am – 10:00 a.m.

Platform 2: *Glial Tumors 1: Cell Biology/ Profiling*
Chairpersons: *Dan Brat, David Zagzag*

9:15-9:30	13	METABOLIC CONTROL OF THE GLYCOLYTIC LEADING EDGE FORMED BY MIGRATORY, PTEN MUTATED ASTROCYTOMA CELLS Marie E Beckner, Xuan Chen, Jiyan An, Roger Abounader, Fatima Burovic, Billy W Day, John Latterra, Ian F Pollack
9:30-9:45	14	CO-LOCALIZATION OF CXCR4 WITH HIF-1 α AND SDF-1 α EXPRESSION IN GLIOBLASTOMAS: IMPLICATIONS FOR ANGIOGENESIS AND GLIOMA CELL INVASION David Zagzag, Luis Chiriboga, Herman Yee
9:45 – 10:00	15	HYPOXIA AND PTEN MODULATE TISSUE FACTOR EXPRESSION AND PLASMA COAGULATION BY MALIGNANT GLIOMA Daniel J Brat, Marcia Pecot, Jayashree Kadire, Yuan Rong, Sarojini N Devi, Erwin G Van Meir

10:00 - 10:30 am REFRESHMENT BREAK

FRIDAY, JUNE 25, 2004
Grand Ballroom A
10:30 – 12:00 p.m.

Platform 3: *Degenerative I: Prion Disease*
Chairpersons: *Pierluigi Gambetti, Stephen DeArmond*

10:30-10:45	16	EXTRACELLULAR PROTEIN DEPOSITION CORRELATES WITH GLIAL ACTIVATION AND OXIDATIVE STRESS IN CREUTZFELDT-JAKOB AND ALZHEIMER'S DISEASE Patrick Cras, Bart Van Everbroeck, Itte Dobbeleir, Michèle De Waele, Jean-Jacques Martin
10:45-11:00	17	WIDESPREAD DISTRIBUTION OF PRP ^{RES} IN THE BRAIN AND IN PERIPHERAL TISSUES OF AN ITALIAN PATIENT WITH VARIANT CREUTZFELDT-JAKOB DISEASE (vCJD) Orso Bugiani, Giorgio Giaccone, Michela Mangieri, Lucia Limido, Raffaella Capobianco, Silvia Suardi, Giuseppe Di Fede, Luca Carsana, Paolo Fociani, Fabrizio Tagliavini
11:00-11:15	18	PROGRAMMED DENDRITIC ATROPHY IN PRION DISEASE Nako Ishikura, Eric J Huang, Jared L Clever, Erik Samayoa, Amy A Tang, Stephen J DeArmond
11:15-11:30	19	MUTATION R208H OF THE PRION PROTEIN GENE IN A PATIENT WITH CREUTZFELDT-JAKOB DISEASE Emmanuelle Uro-Coste, Céline Basset-Leobon, Katell Peoc'h, Olivier Andreoletti, Mathieu Rigal, Sazdovitch Véronique, Haik Stéphane, Hauw Jean-Jacques, Jean-Louis Laplanche, Marie-Bernadette Delisle

11:30-11:45	20	TRANSMISSIBILITY OF CHRONIC WASTING DISEASE OF ELK AND DEER TO HUMANS Qingzhong Kong, Shenghai Huang, Di Wu, Meiling Wang, Difernando Vanegas, Hua Bai, Huayun Deng, Ken Chen, Wenquan Zou, Allen L. Jenny, Katherine O'Rourke, Man-Sun Sy, Shu G Chen, Pierluigi Gambetti
11:45-12:00	21	ACCUMULATION OF PRION PROTEIN IN THE PERIPHERAL NERVOUS SYSTEM OF HUMAN FORMS OF THE DISEASE: AN IMMUNOHISTOCHEMICAL STUDY Chin-Cheng Lee, Francesco Scaravilli, Lu-Ting Kuo, Chwan-Heng Wang, Shu F An

12:10 BUSINESS MEETING I (Grand Ballroom A)

12:50 pm LUNCH

FRIDAY, JUNE 25, 2004

Grand Ballroom B

10:30 – 12:00 pm

Platform 4: Peripheral Nerve/Muscle

Chairpersons: Anders Sima, Mark Becher

10:30 – 10:45	22	MOLECULAR ALTERATIONS UNDERLIE NODAL DEGENERATION IN TYPE 1 DIABETIC NEUROPATHY AND ARE PREVENTED BY C-PEPTIDE Anders AF Sima, Weixian Zhang, Christopher R Pierson
10:45-11:00	23	GENE EXPRESSION PROFILE IN RAT DORSAL ROOT GANGLION (DRG) FOLLOWING SCIATIC NERVE TRANSECTION AND SYSTEMIC NEUROTROPHIN-3 (NT-3) ADMINISTRATION, Lu-Ting Kuo, Shu Fang An, Michael J Groves, Chin-Cheng Lee, Francesco Scaravilli
11:00-11:15	24	PERIPHERAL NEUROPATHY IN LONG-TERM EXPOSURE TO TWO NEUROTOXIC ORGANOPHOSPHATES Bernard S Jortner, Sandra Hancock, Jonathan Hinckley, Laird Williams, Nikola Agatic, Marion Ehrich
11:15-11:30	25	NEMALINE RODS IN MUSCLE BIOPSIES FROM ADULTS: CLINICAL AND HISTOLOGIC CRITERIA FOR NEMALINE ROD MYOPATHY Philip J Boyer, Pravin Khemani, Gil I Wolfe, Susan T Iannaccone, Alan L Naarden, John M Joseph, Dennis K Burns
11:30-11:45	26	INTRANUCLEAR AGGREGATES OF POLY(A) BINDING PROTEIN 2 IN NEUROLOGICALLY NORMAL INDIVIDUALS AND MICE Mark W. Becher, Wieslawa Tlomak, Kelly M. Salceies, Ami Mankodi, Charles Thornton
11:45-12:00	27	ACTIVATION OF SATELLITE CELLS IN REINNERVATED RAT MUSCLE Antje Bornemann, Zhe Zhou

12:10 BUSINESS MEETING I (Grand Ballroom A)

12:50 pm LUNCH FRIDAY, JUNE 25, 2004

Grand Ballroom A

2:00 pm – 4:00 pm

Platform 5: Non-glial Tumors

Chairpersons: David Ellison, Steve Carroll

2:00 – 2:15	28	C-MYC OVEREXPRESSION REPRODUCES THE LARGE CELL/ANAPLASTIC MEDULLOBLASTOMA PHENOTYPE IN XENOGRAFTS Charles G Eberhart, Ty W Abel, Aneeka Chaudhry, Peter C Burger, Duncan Stearns
2:15 – 2:30	29	THE CLINICAL UTILITY OF STRATIFYING MEDULLOBLASTOMAS (MBs) BY A COMBINATION OF DETAILED HISTOPATHOLOGIC EVALUATION AND MOLECULAR CYTOGENETIC ANALYSIS David Ellison, Jayne Lamont, Charles McManamy, Andrew Pearson, Steven Clifford
2:30 – 2:45	30	NEUREGULIN-1 GROWTH FACTORS AND THEIR ERBB RECEPTORS PROMOTE MITOGENESIS IN HUMAN MALIGNANT PERIPHERAL NERVE SHEATH TUMOR CELLS Steven L Carroll, Mark S Stonecypher
2:45 – 3:00	31	IMMUNOHISTOCHEMICAL AND GENETIC INSIGHTS INTO MENINGIOANGIOMATOSIS WITH AND WITHOUT MENINGIOMA: A SERIES OF 17 CASES Arie Perry, Ozlem Kurtkaya, Bernd W Scheithauer, Richard A Prayson, Bette K Kleinschmidt-DeMasters, David H Gutmann

3:00 – 3:15	32	INTRATHECAL APPLICATION OF SAPORIN CONJUGATES LEADS TO DEVELOPMENT OF PITUITARY ADENOMAS IN RATS Marta Margeta, Peter T Ohara, Andrew W Bollen, Luc Jasmin
3:15 – 3:30	33	INI1 EXPRESSION DISTINGUISHES ATYPICAL TERATOID/RHABDOID TUMOR (AT/RT) FROM CHOROID PLEXUS CARCINOMA (CPC) Alexander R Judkins, Peter Burger, Ronald L Hamilton, Bette Kleinschmidt-DeMasters, Arie Perry, Scott Pomeroy, Marc K Rosenblum, Anthony T Yachnis, Lucy B Rorke, Jaclyn A Biegel
3:30 – 3:45	34	MARGINAL ZONE LYMPHOMA (MALTOMA) OF THE CNS: A CLINICOPATHOLOGIC AND GENETIC SERIES OF 7 CASES Pang-hsien Tu, Caterina Giannini, Richard Burack, Brian P O'Neill, Anthony T Yachnis, Arie Perry
3:45 – 4:00	35	LOSS OF HETEROZYGOSITY REVEALS NON-VHL ALLELIC LOSS IN HEMANGIOBLASTOMAS AT 22q13 Marie E Beckner, Eizaburo Sasatomi, Patricia A Swalsky, Ronald L Hamilton, Ian F Pollack, Sydney D Finkelstein

4:00 – 4:30 pm REFRESHMENT BREAK

6:30 - 8:30 pm ANNUAL RECEPTION
Ambassador Reception Hall

FRIDAY, JUNE 25, 2004
Grand Ballroom B
2:00 pm – 4:00 pm

Platform 6: Development/Pediatrics/Genetics
Chairpersons: Kevin Roth, Ed Monuki

2:00 – 2:15	36	CEREBELLAR DYSGENESIS CORRELATES WITH THE TIMING AND EXTENT OF DYSTROGLYCAN DELETION IN CONDITIONAL KNOCKOUT MICE Steven A Moore, Susan E Ross-Barta, Steven Westra, Fumiaki Saito, Albee Messing, Livia Bajenaru, David Gutmann, Kevin P Campbell
2:15 – 2:30	37	INTEGRIN LINKED KINASE (ILK) DELETION FROM MOUSE CORTEX RESULTS IN CORTICAL LAMINATION DEFECTS RESEMBLING COBBLESTONE LISSENCEPHALY Agnieszka Niewmierzycka, René St-Arnaud, Shoukat Dedhar, Louis F Reichardt
2:30 – 2:45	38	<i>Lis1</i> ^{+/-} MICE EXHIBIT MULTIPLE DEFECTS IN NON-RADIAL CELL MIGRATION Ilya Nasrallah, Matthew McManus, MacLean Pancoast, Anthony Wynshaw-Boris, Jeffrey Golden
2:45 – 3:00	39	LINEAGE-NEGATIVE BONE MARROW CELLS TRAVEL BIDIRECTIONALLY IN THE OLFACTORY MIGRATORY STREAM BUT MAINTAIN HEMATOPOIETIC PHENOTYPE Brian E. Moore, Gerald A Colvin, Mark S Dooner, Peter J Quesenberry
3:00 – 3:15	40	MOLECULAR REGULATION OF ETHANOL-INDUCED NEURONAL APOPTOSIS Kevin A Roth, Barbara J Klocke, Lisa Nowoslawski
3:15 – 3:30	41	TOWARD THE FUNCTION OF CLN3 PROTEIN: A PROTEOMIC APPROACH Krystyna E Wisniewski, Mariusz Walus, Elizabeth Kida, Adam A Golabek
3:30 – 3:45	42	A MICROARRAY-BASED METHOD FOR STUDYING MICRO-RNA (miRNA) EXPRESSION Peter T Nelson, Donald A Baldwin, John C Oberholtzer, Zissimos Mourelatos
3:45 – 4:00	43	LEVELS OF DYSBINDIN, A SCHIZOPHRENIA SUSCEPTIBILITY GENE, ARE REDUCED IN THE FRONTAL CORTEX OF PATIENTS WITH SCHIZOPHRENIA Cynthia S Weickert, Mary M Herman, Benjamin W McClintock, Nader Halim, Barbara K Lipska, Thomas M Hyde, Daniel R Weinberger, Richard E Straub, Joel E Kleinman

4:00 – 4:30 pm REFRESHMENT BREAK

6:30 - 8:30 pm ANNUAL RECEPTION
Ambassador Reception Hall

POSTER PRESENTATIONS

FRIDAY JUNE 25, 8:00 am - 5:00 pm
SATURDAY JUNE 26, 8:30 am - 5:00 pm
Exhibit Hall

Posters will be displayed all day Friday & Saturday

Poster Sessions: Alzheimer's Disease/Aging (#44-56), Degenerative/Non-AD (#57-72), Developmental/Pediatric (#73-80), Infectious Dis (#81-83), Methods (#84-85), , Peripheral Nerve/Muscle (#86-93), Toxic/Metabolic (#94-97), Trauma (#98-99), Glial Tumors (#100-122), Non-glial Tumors (#123-150), Vascular (#151-154)

Poster 7: Alzheimer's Disease/Aging	
44	DIFFERENTIAL REGULATION OF HIPPOCAMPAL FUNCTION AND PLASTICITY BY LUTEINIZING HORMONE DURING NORMAL AGING AND ALZHEIMER DISEASE Gemma Casadesus, Kate M Webber, Richard L Bowen, Craig S Atwood, Miguel A Pappolla, Rudy J Castellani, Arun K Raina, George Perry, Mark A Smith
45	IMPROVED HIPPOCAMPAL FUNCTION IN AGED SWAPP MICE AFTER PHARMACOLOGICAL REDUCTION OF LUTEINIZING HORMONE RELEASE WITH LEUPROLIDE ACETATE Kate M Webber, Gemma Casadesus, Osamu Ogawa, Richard L Bowen, Craig S Atwood, Miguel A Pappolla, George Perry, Mark A Smith
46	PAPILLOMAVIRUS-LIKE PARTICLE ABETA VACCINE INDUCES SPECIFIC ANTIBODY RESPONSE, AND PREVENTS BEHAVIORAL IMPAIRMENT IN APP/PS1 TRANSGENIC MICE Eduardo D Zamora, David Borchelt, Gay Rudow, Kathy Conant, Coryse Hillaire, Anne Handisurya, Reinhart Kirnbauer, Juan C Troncoso
47	ALTERED EXPRESSION OF GROUP I AND GROUP II METABOTROPIC GLUTAMATE RECEPTORS IN THE HIPPOCAMPUS OF PATIENTS WITH ALZHEIMER DISEASE Hyoung-gon Lee, Xiongwei Zhu, Michael J. O'Neill, George Perry, Mark A. Smith
48	REDOX-ACTIVE IRON OXIDIZES RIBOSOMAL RNA IN ALZHEIMER BRAIN Kazuhiro Honda, Mark A Smith, Akihiko Nunomura, Peggy LR Harris, Sandra L Siedlak, George Perry
49	CHRONIC OVEREXPRESSION OF MONOCYTE CHEMOATTRACTANT PROTEIN-1 IN CENTRAL NERVOUS SYSTEM CAUSES DELAYED ENCEPHALOPATHY VIA IMPAIRED PHAGOCYTSIS OF MICROGLIA IN MICE DeRen Huang, Jerome Wujek, Graham Kidd, Toby T He, Astrid Cardona, Meggan Meggan, Erica J Stein, Jacqueline Kish, Marie Tani, Richard M Ransohoff
50	ASYMMETRIC SUPERFICIAL MICROVACUOLATION IN PRIMARY PROGRESSIVE APHASIA WITH ALZHEIMER PATHOLOGY Eileen H Bigio, Laura Frantzen, Pamela Shaw, Nancy A Johnson, Sandra Weintraub, Alfred W Rademaker, M-Marsel Mesulam
51	PHOSPHORYLATION MODULATED OXIDATIVE MODIFICATION OF NEUROFILAMENT PROTEIN Quan Liu, Mark A Smith, Sandra L Siedlak, Peggy LR Harris, Ricardo B Maccioni, Lawrence M Sayre, George Perry
52	BRAIN-SPECIFIC PKM-ZETA IS INVOLVED IN ALTERED SYNAPTIC PLASTICITY IN ALZHEIMER'S DISEASE Charles Y Shao, John F Crary, Todd C Sacktor, Suzanne S Mirra
53	RELATIONSHIP BETWEEN RADIATION INJURY AND ALZHEIMER-RELATED NEURODEGENERATIVE CHANGES Miguel A Riudavets, Hernando Mena, John-Paul Bouffard, Glenn D Sandberg, Elisabeth J Rushing
54	NUCLEOCYTOPLASMIC TRANSPORT IN ALZHEIMER'S DISEASE: PRELIMINARY OBSERVATIONS Lynette G Sheffield, Jennifer Snyder, Suzanne S Mirra
55	DIAGNOSIS OF ALZHEIMER'S DISEASE IN AN EXHUMED DECOMPOSED BRAIN AFTER TWENTY MONTHS OF BURIAL IN A DEEP GRAVE Bennet I Omalu, Abdulrezak Shakir, Leon Rozin, Cyril H Wecht
56	CALCOFLUOR STAINS AMYLOID-BETA DEPOSITS Rudy J Castellani, Anne E Fortino, Ralph Common, George Perry, Bernardino Ghetti, Mark A Smith
Poster 8: Degen Non-AD	
57	NEUROFIBRILLARY TANGLE-RELATED SYNAPTIC ALTERATIONS IN THE SPINAL CORD OF TRANSGENIC MICE EXPRESSING MUTANT HUMAN TAU Omi Katsuse, Wen-lang Lin, Dennis W Dickson
58	αB-CRYSTALLIN-IMMUNOREACTIVE BALLOONED NEURONS ARE A CONSTANT FEATURE OF LEWY BODY DISEASE Yasuhiro Fujino, Yoshio Tsuboi, Dennis W Dickson
59	LEWY NEURITE BURDEN IN THE ANTERIOR CINGULATE GYRUS: CLINICOPATHOLOGIC CORRELATION Kyle B Womack, C Munro Cullum, Linda S Hynan, Christa L Hladik, Myron F Weiner, Charles L White

FRIDAY JUNE 25, 8:00 am - 5:00 pm
 SATURDAY JUNE 26, 8:30 am - 5:00 pm
 Exhibit Hall

Posters (continued):

60	ROLE OF FRACTALKINE AND FRACTALKINE RECEPTOR IN MICROGLIA NEUROTOXICITY Astrid E Cardona, DeRen Huang, Grahame Kidd, Margaret E Sasse, Sergio Lira, Donald Cook, Steffen Jung, Dan R Littman, Richard M Ransohoff
61	SCRAPIE STRAIN PROGRESSION DETERMINES OXIDATIVE STRESS LEVELS AND GLIAL ACTIVATION IN C57BL XVM MICE Patrick Cras, Bart Van Everbroeck, Jan Fraser, David Brown
62	APOPTOTIC PATHWAYS DIFFER IN PRIMARY DIABETIC ENCEPHALOPATHY IN TYPE 1 AND TYPE 2 DIABETES Zhen-guo Li, Anders A.F. Sima
63	ER ALTERATION REVEALED BY IMMUNOHISTOCHEMISTRY FOR CHAPERONE IN THE ANTERIOR HORN CELLS IN AMYOTROPHIC LATERAL SCLEROSIS Kiyomitsu Oyanagi, Mineo Yamazaki, Kazuhiko Watabe, Emiko Kawakami, Manabu Wada, Takashi Morita, Hitoshi Takahashi, Shuichi Kato, Toshio Mizutani, Hideaki Hayashi
64	STRAIN DIFFERENCE INFLUENCES THE AXONAL DEGENERATION WITH FORMATION OF AXONAL SPHEROIDS IN HIPPOCAMPUS OF NIEMANN-PICK TYPE C MOUSE Shoichi Takikita, Takahiro Fukuda, Takashi Yagi, Kinuko Suzuki
65	DEMENTIA WITH UNIQUE PATTERN OF DISTRIBUTION OF NEUROFIBRILLARY TANGLES John C Hedreen, Victoria Zhukareva, John Q Trojanowski, Virginia M-Y Lee
66	NEUROFILAMENT INCLUSION BODY DISEASE WITH EARLY ONSET FRONTOTEMPORAL DEMENTIA AND PRIMARY LATERAL SCLEROSIS Ian RA Mackenzie, Howard Feldman
67	NOVEL METHOD FOR ISOLATION OF PRION PROTEIN Frank O. Bastian, Michael E. McDermott, Srikanta Dash, Robert F. Garry
68	A VALINE HOMOZYGOUS PRP ^{Sc} TYPE 1 CREUTZFELDT-JAKOB DISEASE YOUNG ADULT WITH LONG DURATION OF PSYCHIATRIC SYMPTOMS PRECEDING NEUROLOGICAL SIGNS Ana L Taratuto, Christian Begue, Maria A Amengual, Jorge Campos, Maria T Goicochea, Facundo Manes, Marcelo Schultz, Gustavo Sevlever, Horacio E Martinetto
69	CLINICAL, MOLECULAR GENETIC AND NEUROPATHOLOGIC STUDIES OF AN INDIVIDUAL WITH THE A53T MUTATION IN ALPHA-SYNUCLEIN Keiji Yamaguchi, Elizabeth J Cochran, Jill R Murrell, Mihael H Polymeropoulos, Kathleen M Shannon, Michel Goedert, Bernardino Ghetti
70	ALPHA-SYNUCLEIN DEPOSITS IN THE SUBSTANTIA NIGRA OF INDIVIDUALS WITH GERSTMANN-STRÄUSSLER-SCHEINKER DISEASE (F198S-129V) Keiji Yamaguchi, Pedro Piccardo, Fabrizio Tagliavini, Orso Bugiani, Giorgio Giaccone, Francine Epperson, Leticia Miravalle, Martin R Farlow, Jill R Murrell, Marla Gearing, Stephen R Dlouhy, Suzanne S Mirra, Bernardino Ghetti
71	LEWY BODY PATHOLOGY IN PARKINSON DISEASE AND DEMENTIA WITH LEWY BODIES Christine M Hulette, Adam McLaurin, John F Ervin, Jeffery Vance, Donald E Schmechel
72	ROLE OF THE POLYMORPHISM AT CODON 129 OF THE PRION PROTEIN GENE IN THE PHENOTYPIC EXPRESSION OF GERSTMANN-STRÄUSSLER-SCHEINKER DISEASE ASSOCIATED WITH THE F198S MUTATION Bernardino Ghetti, Leticia Miravalle, Keiji Yamaguchi, Francine Epperson, Jill R Murrell, Tony Perkins, Siu Hui, Martin R Farlow, Pedro Piccardo, Stephen R Dlouhy
Poster 9: Dev/Pediatric	
73	NEURONAL MIGRATION DEFECTS IN MEROSIN-DEFICIENT MUSCULAR DYSTROPHY Dimitri P Agamanolis, Bahig Shehata, Amilcar A Castellano-Sanchez
74	PATHOLOGY OF HYPOTHALAMIC HAMARTOMAS -- A REVIEW OF 28 CASES Stephen W Coons, Harold L Rekate, Yu-tze Ng, John F Kerrigan
75	MORPHOMETRIC ANALYSIS OF S6 PROTEIN PHOSPHORYLATION IN CORTICAL DYSPLASIA WITH NEURONAL CYTOMEGALY Ivan A Klement, Harry V Vinters
76	HISTOPATHOLOGY AND DIFFERENTIAL EXPRESSION OF GLUTAMATE RECEPTOR SUBUNITS IN HUMAN AND RAT NEURONAL MIGRATION DISORDERS Min-Cheol Lee, Young-Seon Kim, Myeong-Kyu Kim, Young-Jong Woo, Woong-Ki Chung, Jae-Hyoo Kim, Hyung-Ihl Kim

77	BILATERAL PERISYLVIAN ULEGYRIA AS A CAUSE OF PSEUDOBULBAR PALSY MENTAL RETARDATION AND SURGICALLY-REMEDEABLE EPILEPSY Min-Cheol Lee, Myeong-Kyu Kim, Young-Jong Woo, Jae-Hyoo Kim, Hyung-ihl Kim, Andre Palmi
78	EVIDENCE OF COMMON MOLECULAR ORIGINS OF CORTICAL TUBER AND CHORDOMA IN A TUBEROUS SCLEROSIS PATIENT Subhojit Roy, Michael L Smith, Leslie L Sutton, Alexander R Judkins
79	ABBERANT PHOSPHORYLATION OF TAU IN FUKUYAMA-TYPE CONGENITAL MUSCULAR DYSTROPHY Yuko Saito, Yasufumi Motoyoshi, Kenji Kashima, Naotaka I Shimomura, Tatsushi Toda, Imaharu Nakano, Masato Hasegawa, Shigeo Murayama
80	NEUROPATHOLOGY OF SEIZURES IN THE IMMATURE RABBIT Javad Towfighi, Cathy Housman, Robert M Brucklacher, Robert C Vannucci
Poster 10: Infectious Disease	
81	NEUROPATHOLOGIC FINDINGS IN A WELL-DOCUMENTED CASE OF CHRONIC LYME DISEASE Jenny Libien, Kenneth B Liegner, Brian Fallon, Carolyn B Britton, Cid Diesta, Bryan Ebert, James E Goldman
82	GRANULOMATOUS AMEBIC ENCEPHALITIS IN A PATIENT WITH GARDNERS SYNDROME AND MULTI-ORGAN TRANSPLANT Kate A McFadden, Ronald L Hamilton, Govinda S Visvesvara, Paul Gardner, Marta E Couce
83	IMMATURE GRANULOCYTE PREDOMINANCE IN ACUTE BACTERIAL MENINGITIS Reade A Quinton, Loren E. Clarke, Javad Towfighi, Jeffrey J Barnard, Charles L White, III, Dennis K Burns, Rene L Galindo, Philip J Boyer
Poster 11: Methods	
84	A REPORT ON THE USE OF SERIAL CYTOCHROME C OXIDASE (COX) AND SUCCINATE DEHYDROGENASE (SDH) ENZYME HISTOCHEMISTRY TO SCREEN FOR MITOCHONDRIAL DNA-ENCODED DEFECTS IN CNS TISSUE: APPLICATIONS IN ALZHEIMERS DISEASE AND GLIOMAS Bradley B Miller, Maria-Beatriz S Lopes
85	BRAIN EXPRESSION AND DIAGNOSTIC UTILITY OF MONOCLONAL ANTIBODY D2-40, A MARKER OF LYMPHATIC ENDOTHELIUM Subhojit Roy, Paul J Zhang
Poster 12: Nerve/Muscle	
86	HUMAN CAUDA EQUINA: A MORPHOMETRIC ANALYSIS Howard T Chang, Karen M Jones
87	NOCICEPTIVE SENSORY NEUROPATHY IN TYPE 1 DIABETES IS PREVENTED BY C-PEPTIDE Hideki Kamiya, Anders AF Sima
88	DESMINOPATHY - A NEW MUTATIONAL FORM Hans H Goebel, Andrea Nägele, Peter Fritz, Udo Sechtem, Lev G Goldfarb
89	LIMB-GIRDLE MUSCULAR DYSTROPHY IN THE USA: DISTRIBUTION OF IMMUNOPHENOTYPES AND GENOTYPES FROM AN ONGOING MULTI-CENTER COLLABORATIVE STUDY Steven A. Moore, Christopher J. Shilling, Steven Westra, Matthew P. Wicklund, Charlotte A. Brown, Daniel E. Michele, Catherine Stolle, Kevin P. Campbell, Gerald M. Fenichel, Robert C. Griggs, John T. Kissel, Katherine D. Mathews, Alan Pestronk, Cheryl Wall, Jerry R. Mendell
90	INTRANUCLEAR ROD MYOPATHY: A CASE REPORT Vassil Kaimaktchiev, Hans Goebel, Nigel Laing, Michael Narus, Douglas Weeks, Randal Nixon
91	MUSCLE BIOPSY FINDINGS IN GULF WAR VETERANS Charles S Specht, Michael R Lewin-Smith, Linda A Murakata, Hernando Mena, Victor F Kalasinsky, Albin L Moroz, Florabel G Mullick
92	CONGENITAL MYOPATHIES: PROGRESSIVE MORPHOLOGICAL CHANGES ASSOCIATED TO COURSE Ana L Taratuto, Maria Saccoliti, Fabiana Lubieniecki, Alicia L Panigazzi, Norma B Romero
93	LATE ONSET MELAS DUE TO A RARE MITOCHONDRIAL DNA MUTATION Di Tian, Bradford C Dickerson, Ronan J Walsh, Fred H Hochberg, E Tessa Hedley-Whyte
Poster 13: Tox/Metabolic	
94	CHILDHOOD NEURONAL CEROID-LIPOFUSCINOSIS: CHARACTERIZATION OF SIX VENEZUELAN PATIENTS Jose J Cardozo, Gabriel J Arismendi, Joaquin A Pena, Eduardo Mora, Daniela P Cardozo
95	LATE INFANTILE NEURONAL CEROID LIPOFUSCINOSIS DUE TO HETEROZYGOUS CLN2 MUTATIONS INCLUDING A NOVEL T3915G POINT MUTATION IN ONE ALLELE C R Pierson, B Darras, W Xin, U De Girolami
96	CEREBRAL DAMAGE FOLLOWING HEAT STROKE Dan Bensimhon, Céline Bazille, Catherine Baglin, Jacqueline Mikol, Françoise Gray
97	NEUROPATHOLOGIC CORRELATION WITH DIFFUSION WEIGHTED IMAGING IN DELAYED HYPOXIC-ISCHEMIC LEUKOENCEPHALOPATHY Barbara I Germin, Toshio Moritani, James M Powers
Poster 14: Trauma	

98	BETA AMYLOID PRECURSOR PROTEIN (BETA APP) IMMUNOHISTOCHEMISTRY DETECTS AXONAL INJURY IN LESS THAN 60 MINUTES AFTER HUMAN BRAIN TRAUMA Safa T Al-Sarraj, Tibor Hortobagyi, Susan Wise
99	CHRONIC TRAUMATIC ENCEPHALOPATHY AND THE NATIONAL FOOTBALL LEAGUE Bennet I Omalu
Poster 15: Glial Tumors	
100	GLIOBLASTOMA MULTIFORME: A STEM NEOPLASIA? Romano Ferracini, Giovanna Cenacchi, Antonia Conti, Marina Del Vecchio
101	GENE EXPRESSION PROFILING OF PSEUDOPALISADING PERINECROTIC CELLS IN GLIOBLASTOMA Shumin Dong, Catherine L Nutt, Anat O Stemmer-Rachamimov, David N Louis
102	POTENTIAL RISK FACTORS FOR GLIOBLASTOMA MULTIFORME (GBM): DATA FROM THE HONOLULU HEART PROGRAM/HONOLULU ASIA AGING STUDY (HHP/HAAS) James S Nelson, Cecil M Burchfiel, Robert D Abbott, Desta Fekedulegn, Michael E Andrew
103	SUPRATENTORIAL ANAPLASTIC PILOCYTIC ASTROCYTOMA Naiel Hafez, William C Broadus, Nitya R Ghatak
104	TANYCYTOMA OF THE SPINAL CORD OF AN ADULT Robert L Schelper, Steve K Landas, Howard T Chang
105	CLASSIFICATION AND GRADING OF PEDIATRIC ASTROCYTIC NEOPLASMS, EMPHASIZING UNUSUAL HISTOLOGICAL PATTERNS Lisa Pate, Anuradha Banerjee, Nalin Gupta, Tarik Tihan
106	PROGRESSION OF AN INTRAMEDULLARY SPINAL CORD GANGLIOGLIOMA TO PRIMITIVE NEUROECTODERMAL TUMOR (PNET): A CASE REPORT AND REVIEW OF THE LITERATURE Elizabeth A Bundock, Yogesh M Bhatt, Liliana Goumnerova, Rebecca D Folkert
107	GANGLIOGLIOMA OF THE SPINAL CORD IN CHILDREN Jennifer M Raffel, Alfredo Quinones-Hinajosa, Tarik Tihan
108	PLEOMORPHIC XANTHOASTROCYTOMA: REPORT OF A CASE WITH NECROSIS, AND UNDERLYING GANGLIOGLIOMA/CORTICAL DYSPLASIA Meena B Bhattacharjee, Odile David, Philip Daroca, John Walsh, Carlos A Garcia
109	CEREBELLAR GLIOBLASTOMA, PLEOMORPHIC XANTHOASTROCYTOMA, OR DESMOPLASTIC INFANTILE GANGLIOGLIOMA? Howard T Chang, Julius G Latorre, Seung Hahn, Ronald Dubowy, Robert L Schelper
110	WELL-DIFFERENTIATED GLIAL NEOPLASMS WITH FEATURES OF OLIGODENDROGLIOMA AND DYSEMBRYOPLASTIC NEUROEPITHELIAL TUMORS IN THE PEDIATRIC POPULATION: A REPORT OF FOUR CASES Nicholas P Byrne, Peter C Burger, Rebecca Spies-Swain, Patricia T Goldthwaite, Tarik Tihan
111	ASSESSMENT OF ALTERNATIVE METHODS FOR ESTIMATING THE MIB-1 LABELING INDEX Anil Bagri, Peter C Burger, Andrew W Bollen, Tarik Tihan
112	p16 IMMUNOHISTOCHEMISTRY IN GLIAL TUMOURS Peter V Gould, Leo Cantin, Claude Picard, Daniel Lacerte, André Turmel
113	FISH MARKERS IN DIFFUSE ASTROCYTOMAS Ryan T Mott, Kristi C Turner, Roger E McLendon
114	IMMUNOHISTOCHEMICAL STUDY OF THE EXPRESSION OF P27 AND SKP2 PROTEINS IN ASTROCYTOMAS: COMPARISON AMONG GEMISTOCYTIC ASTROCYTOMAS, GLIOBLASTOMAS AND LOW-GRADE ASTROCYTOMAS Qing Li, Xiaohu Yang, Christine E Sheehan, Jeffrey S Ross, Jiang Qian
115	SIMULTANEOUS EPIDERMAL GROWTH FACTOR RECEPTOR (EGFR) AMPLIFICATION AND TP53 EXPRESSION IN HIGH-GRADE ASTROCYTOMAS: A TISSUE MICROARRAY STUDY Teresa Ribalta, Yolanda Ruano, Concepción Fiaño, José Luis Hernandez-Moneo, Adriana Casado, Ignacio Toscas, Pedro Martinez, Manuela Mollejo, Barbara Melendez
116	MOLECULAR ANALYSIS OF EPIDERMAL GROWTH FACTOR RECEPTOR (EGFR) AND TP53 IN HUMAN GLIOMAS. A TISSUE MICROARRAY-BASED STUDY Yolanda Ruano, Barbara Meléndez, Concepción Fiaño, José Luis Hernandez-Moneo, Adriana Casado, Ignacio Toscas, Pedro Martinez, Manuela Mollejo, Teresa Ribalta
117	DOUBLECORTIN EXPRESSION IN HUMAN PRIMARY BRAIN TUMORS. IS THERE A ROLE IN TUMOR INVASIVENESS? Marie-Claire Daou, Alonzo H Ross, Thomas W Smith

FRIDAY JUNE 25, 8:00 am - 5:00 pm
 SATURDAY JUNE 26, 8:30 am - 5:00 pm
 Exhibit Hall

Posters (continued):

118	RECURRENT ANAPLASTIC OLIGODENDROGLIOMA WITH 1P/19Q LOSS AND A PROGRESSIVE INCREASE IN P53 IMMUNOREACTIVITY : CASE STUDY Narendra Nathoo, Mairead Commene, Abhay Varma, Olga B Chernova, Glen Stevens, Susan M Staugaitis, Michael A Vogelbaum
119	CHARACTERIZATION OF THE GL261 INTRACRANIAL MOUSE BRAIN TUMOR MODEL Douglas C Miller, David Zagzag, Elizabeth Arena, Elizabeth W Newcomb
120	DIAGNOSTIC AND PROGNOSTIC SIGNIFICANCE OF GLYCOLIPID GLYCOSYLTRANSFERASE mRNAs Janet L Oblinger, Dennis K Pearl, Cindy L Boardman, Thomas W Prior, Bernd W Scheithauer, Robert Jenkins, Peter C Burger, Allan J Yates
121	TRAIL--INDUCED APOPTOSIS IS INITIATED IN THE CAVEOLAE OF U-1242MG GLIOMA CELLS Ola M Omran, Hany E Saqr, Allan J Yates
122	CD44S EXPRESSION PATTERNS OF INFILTRATING GLIOMAS: A GRAY MATTER Sean Kearns, Nathalie Toussaint, Biorn Scheffler, Ronald Mandel, Dennis Steindler, Sean Sullivan, Anthony T Yachnis,
Poster 16: NG Tumors	
123	EXPRESSION OF THE NEURAL RNA-BINDING PROTEIN, MUSASHI 1 IN HUMAN EMBRYONAL TUMORS IN CENTRAL NERVOUS SYSTEM Qian Wu, John E Donahue, Charles Chan, Rose Tavares, Edward Stopa
124	WNT SYSTEM AND DIFFERENTIATION IN MEDULLOBLASTOMA CELL LINES Giovanna Cenacchi, Giovanni Capranico, Roberta Salaroli, Alessandra Russo, Claudio Ceccarelli, Massimo Derenzini, Felice Giangaspero
125	MEDULLOBLASTOMA WITH EXTENSIVE NODULARITY MASQUERADING AS LHERMITTE-DUCLOS DISEASE Christine E Fuller, Fred Laningham, Jesse J Jenkins, Jennifer Havens, Robert A Sanford
126	PEDIATRIC NEUROBLASTIC TUMOR WITH ABUNDANT NEUROPIIL AND TRUE ROSETTES: REPORT OF 2 CASES WITH MOLECULAR ANALYSIS BY FLUORESCENCE IN SITU HYBRIDIZATION Christine E Fuller, Maryam Fouladi, Amar Gajjar, James Dalton, Robert A Sanford, Kathleen Helton
127	INTRADURAL EXTRAMEDULLARY ATYPICAL TERATOID/RHABDOID TUMOR OF THE SPINAL CORD Charuhas G Deshpande, Arie Perry, Mary K Gumerlock, Kalliopi G Petropoulou, Kar-Ming Fung
128	MESENCHYMAL DIFFERENTIATION IN MALIGNANT RHABDOID TUMORS Jack Raisanen, Dinesh Rakheja, Kimmo J Hatanpaa, Dennis K Burns, Suash Sharma, Christa L Hladik, Charles F Timmons, Charles L White
129	PTEN EXPRESSION IN GANGLION CELL TUMORS: AN IMMUNOHISTOCHEMICAL STUDY Ty W Abel, Suzanne J Baker, Melissa Fraser, Tarik Tihan, Peter C Burger, Charles G Eberhart
130	PIGMENTED CENTRAL NEUROCYTOMA Tim-Rasmus Kiehl, Steve N Kalkanis, David N Louis
131	SPINAL CORD GLIONEURONAL TUMOR WITH SYRINGOMYELIA Sajjad Syed, Ravi Raghavan
132	PROLIFERATION IN NORMAL PINEAL AND PINEAL TUMORS Cynthia T Welsh, Michael T Smith
133	CLAUDIN-1 AND EMA EXPRESSION IN ATYPICAL MENINGIOMAS: FURTHER STUDIES WITH A NOVEL MARKER FOR ARACHNOIDAL CELLS Meena B Bhattacharjee, Adekunle M Adesina, J. Clay Goodman, Suzanne Z Powell
134	GENERATION OF IMMORTALIZED CELL LINES DERIVED FROM BENIGN BRAIN TUMORS BY hTERT TRANSDUCTION Werner Paulus, Sylvia Puttmann-Cyrus
135	PRIMARY MENINGEAL SARCOMATOSIS (PMS): A CASE REPORT WITH CYTOGENETIC FINDINGS AND A REVIEW OF THE LITERATURE Chris R Pierson, Keith L Ligon, Liliana C Goumnerova, Kathleen Richkind, Umberto De Girolami
136	EPIDERMAL GROWTH FACTOR RECEPTOR IS NOT AMPLIFIED IN SCHWANNOMAS Brian J Yoder, Gene H Barnett, Richard A Prayson
137	INFLAMMATORY MYOFIBROBLASTIC TUMORS OF THE CENTRAL NERVOUS SYSTEM AND THE ORBIT Sung-Hye Park, Yoon Kyung Jeon, Yeon-Lim Suh
138	D2-40, A NOVEL MONOCLONAL ANTIBODY AS A MARKER TO DISTINGUISH HEMANGIOBLASTOMAS FROM RENAL CELL CARCINOMAS Subhojit Roy, Albert Chu, Alexander R Judkins, Paul J Zhang,
139	CASE REPORT: PRIMARY CEREBRAL EPITHELIOID HEMANGIOENDOTHELIOMA Cristina Montalvo, Suzanne Z Powell, Carolina Gutierrez
140	NEVUS OF OTA AND CONTRALATERAL MALIGNANT MELANOMA: CASE REPORT Linda Buckleair, Daniel Yoshor, Bharat Guthikonda, Suzanne Z Powell

141	PRIMARY CENTRAL NERVOUS SYSTEM T-CELL LYMPHOMA IN A 33 YEAR-OLD MAN: REPORT OF A CASE AND REVIEW OF THE LITERATURE Vishal S Chandan, Robert L Schelper, Anthony E Shrimpton, Robert E Hutchison, Howard Chang
142	NEUROPATHOLOGY CHARACTERISTIC OF PARANEOPLASTIC OPSOCLONUS-MYOCLONUS IN A PATIENT WITH LYMPHOMA Malcolm Galloway, Tom S Jacques, Francesco Scaravilli
143	PRIMARY HODGKIN'S DISEASE IN THE BRAIN OF AN HIV-POSITIVE ADULT Terri Haddix, John Prichard, Roger Warnke, Hannes Vogel
144	ALTERED TUMOR KINETICS INDUCED BY TIMP-1 OVEREXPRESSION IN LUNG VS PANCREATIC CARCINOMA METASTATIC TO BRAIN Aryn M Rojiani, Mumtaz V Rojiani
145	CNS PARANEOPLASTIC SYNDROME IN RELATION TO TWO CANCERS AND CEREBELLAR ATAXIA Aly G Saad, Adebowale J Adeniran, Kenneth Wagner, James Wolfe, Daniel Kanter, deCourten-Myers Gabrielle,
146	FAMILIAL CHORDOMAS: A MORPHOLOGIC AND IMMUNOHISTOCHEMICAL STUDY IN RELATION TO SPORADIC TUMORS Martha Quezado, Mariarita Santi, Parry Dilys, Elisabeth Rushing
147	ONCOCYTIC VARIANT OF CHOROID PLEXUS CARCINOMA IN AN ADULT James E Madory, Cynthia T Welsh, Michael T Smith
148	OCT4 IS SUPERIOR TO PLAP IN THE DIAGNOSIS OF CENTRAL NERVOUS SYSTEM GERMINOMA Eyas M Hattab, Pang-hsien Tu, Jon D Wilson, Liang Cheng
149	C-KIT AND HER2/NEU EXPRESSION IN PRIMARY INTRACRANIAL GERMINOMA Eyas M Hattab, Pang-hsien Tu, Jon D Wilson, Liang Cheng
150	CYTOKERATIN CK7/CK20 PROFILE IN THE EVALUATION OF MALIGNANT PROGRESSION AND METASTASIS OF A SILENT ACTH PITUITARY ADENOMA Stephen W Coons, William L White, Iman Feiz-Erfan
Poster 17: Vascular	
151	CEREBROVASCULAR DISEASE: ITS RELATIONSHIP WITH CARDIOVASCULAR AND RENAL PATHOLOGY IN 134 CLINICAL AUTOPSIES Gabriel J Arismendi, Jose J Cardozo, Gustavo J Vilchez, Mary C Fernandez-Abreu, Daniela P Cardozo
152	VASCULAR MALFORMATION-TYPE INTRAMEDULLARY CHANGES IN SPINAL CORD BIOPSIED FOR SUSPICION OF NEOPLASIA Fausto J Rodriguez, Brian Crum, Bernd W Scheithauer, Bahram Mokri, Caterina Giannini
153	INTRAVASCULAR LYMPHOMA AND PRIMARY CENTRAL NERVOUS SYSTEM ANGIITIS CAUSE WIDESPREAD AXONAL INJURY Ross Reichard, Kelly Lear-Kaul, Christa Hladik, Charles L White, III
154	HEME OXYGENASE-1 IS EXPRESSED IN CAROTID ATHEROSCLEROTIC PLAQUES INFECTED BY HELICOBACTER PYLORI AND IS MORE PREVALENT IN ASYMPTOMATIC SUBJECTS Gustavo Sevlever, Agustina R Villamil, Christine Zedda, Juan C Parodi, Sergio Garrido, Maria I Sarchi, Jorge Boczkowski, Sebastián Ameriso

SATURDAY, JUNE 26, 2004
Grand Ballroom A
8:30 am – 10:15 am

Platform 18: *Degenerative II: Neuropathology*
Chairpersons: *Dennis Dickson, Eileen Bigio*

8:30 - 8:45	155	SPASTIC PARAPARESIS IS AN IMPORTANT CLINICAL FEATURE OF THE L166P PRESENILIN 1 MUTATION IN FAMILIAL ALZHEIMER DISEASE Philip J Boyer, Kevin R Hargrave, Kevin Scott, Pedro Piccardo, Jill R Murrell, Javad Towfighi, Bernardino Ghetti
8:45- 9:00	156	"AMYGDALA PREDOMINANT" LEWY BODY DISEASE: A SUBTYPE OF ALZHEIMER'S DISEASE ASSOCIATED WITH FEMALE GENDER AND A MORE RAPID RATE OF DECLINE James B Leverenz, Mathew Kraybill, Thomas J Montine, David Nochlin, James D Bowen, Wayne C McCormick, Linda Teri, Walter A Kukull, Eric B Larson, Debby W Tsuang,
9:00- 9:15	157	ATYPICAL PROGRESSIVE SUPRANUCLEAR PALSY WITH CORTICOSPINAL TRACT DEGENERATION: A CLINICOPATHOLOGICAL STUDY OF FOUR CASES Dennis W Dickson, Omi Katsuse
9:15- 9:30	158	UNIQUE PURKINJE CELL DEGENERATION IN 16Q-LINKED AUTOSOMAL DOMINANT CORTICAL CEREBELLAR ATROPHY Hidehiro Mizusawa, Kinya Ishikawa, Kiyoshi Owada, Shuta Toru, Gen Ishida, Manabu Gomyoda, Nobuo Sakurai, Mari Yoshida, Yoshio Hasizume

9:30 - 9:45	159	DEVELOPMENT OF TISSUE MICROARRAYS FOR NEURODEGENERATIVE DISEASE RESEARCH Alexander R Judkins, Daniel Martinez, John Q Trojanowski, Mark S Forman
9:45 - 10:00	160	COTTON WOOL PLAQUES IN FAMILIAL ALZHEIMER DISEASE WITH <i>PRESENILIN 1</i> MUTATIONS. CLINICAL AND NEUROPATHOLOGIC HETEROGENEITY Bernardino Ghetti, Pedro Piccardo, Leticia Miravalle, Ruben Vidal, Elizabeth J Cochran, Javad Towfighi, Phillip Boyer, Jill R Murrell, Martin R Farlow, Atsuo Koto, Masaki Takao

10:15: - 10:45 am REFRESHMENT BREAK

10:45 SAUL R. KOREY LECTURE (Grand Ballroom)
The Road Not Taken

James M. Powers, MD

11:45 am BUSINESS MEETING II (Grand Ballroom A)

12:45 pm LUNCH

SATURDAY, JUNE 26, 2004
Grand Ballroom B
8:30 am - 10:15 am

Platform 19: Glial Tumors II: Biomarkers
Chairpersons: David Louis, Christine Fuller

8:30 – 8:45	161	TOPOGRAPHIC DISTRIBUTION, GENOMIC PATTERN AND TIMING OF 1p ALLELIC LOSS PREDICTS TREATMENT RESPONSIVENESS IN GLIOMAS Raj K Rolston, Robert Maciunas, Sydney D Finkelstein, Patricia A Swalsky, Stephen Sagar, Mark L Cohen
8:45 – 9:00	162	OLIGODENDROGLIOMA, NEUROCYTOMA: RESOLVING CLASSIFICATION ISSUES Douglas C Miller
9:00 – 9:15	163	DETERMINATION AND SIGNIFICANCE OF THE TIMING OF 1p/19q ALLELIC LOSS IN RELATION TO AGGRESSIVE MUTATIONS (9p, 10q, 17p) IN GLIOMAS Roger McLendon, Patricia Swalsky, Sydney Finkelstein
9:15 – 9:30	164	RELATIONSHIP OF THE PATTERN OF 1p/19q ALLELIC LOSS TO THE HISTOLOGIC TYPE OF GLIOMA Roger McLendon, Patricia Swalsky, Sydney Finkelstein
9:30 – 9:45	165	SMALL CELL ASTROCYTOMA: A CLINICOPATHOLOGICALLY AND GENETICALLY DISTINCT VARIANT THAT MIMICS ANAPLASTIC OLIGODENDROGLIOMA Arie Perry, David H George, Peter C Burger
9:45 – 10:00	166	DETAILED DELETION MAPPING OF THE SHORT ARM OF CHROMOSOME 1 IN OLIGODENDROGLIAL TUMORS Ho-keung Ng, Zhi-Qian Dong, Jesse Chung-sean Pang, Wai-sang Poon, Liang-fu Zhou
10:00 – 10:15	167	MOLECULAR CHARACTERIZATION OF PEDIATRIC OLIGODENDROGLIAL NEOPLASMS: THE ST JUDE EXPERIENCE Christine E Fuller, James Dalton, Maryam Fouladi, Kathleen Helton, Larry Kun

10:15: - 10:45 am REFRESHMENT BREAK

10:45 SAUL R. KOREY LECTURE (Grand Ballroom)
The Road Not Taken

James M. Powers, MD

11:45 am BUSINESS MEETING II (Grand Ballroom A)

12:45 pm LUNCH

SATURDAY, JUNE 26, 2004
Grand Ballroom A
1:45 pm – 3:00 pm

Platform 20: Degenerative III: Biochemical

Chairpersons: Carol Miller, Marla Gearing

1:45-2:00	168	FUNCTIONAL STATUS OF CORTICAL M1 CHOLINERGIC RECEPTORS IN ALZHEIMERS DISEASE AND THE LEWY BODY VARIANT OF ALZHEIMERS DISEASE John M Lee
2:00-2:15	169	OVARIETOMY CAUSES CNS A β ACCUMULATION IN RABBITS Thomas G Beach, Lucia I Sue, Amanda Newell, Marissa Poston, Raquel Cisneros, Yoga Pandya, Pamela Potter
2:15-2:30	170	DENN/MADD DOWN-REGULATION AND SYNAPTIC TERMINAL DYSFUNCTION IN AD Carol A. Miller, Celia Williams, Keith Del Villar
2:30-2:45	171	RAGE, LRP-1, AND VASCULAR AMYLOID IN ALZHEIMER'S DISEASE John E Donahue, Conrad E Johanson, John A Duncan, Gerald D Silverberg, Rose Tavares, Virginia Hovanesian, Edward G Stopa
2:45-3:00	172	REDUCED EXPRESSION OF THE MULTIFUNCTIONAL APOLIPOPROTEIN E RECEPTOR LR11 PLAYS AN IMPORTANT ROLE IN ALZHEIMER'S DISEASE PATHOGENESIS Marla Gearing, James J Lah, Kristin L Sager, Katrin Offe, Sara E Dodson, Stephanie C Carter, David A Bennett, Elliott J Mufson, Allan I Levey

SATURDAY, JUNE 26, 2004
Grand Ballroom B
1:45 pm – 3:00 pm

Platform Session 21: Infectious Diseases

Chairpersons: Clayton Wiley, Kymberly Gyure

1:45 – 2:00	173	ABNORMAL WHITE MATTER GENES DRIVE AN ACQUIRED CHANNELOPATHY IN SUBCORTICAL DEMENTIA ASSOCIATED WITH HIV INFECTION Benjamin B Gelman, Kimberly Schuenke, Vicki M Soukup
2:00 – 2:15	174	PCNA EXPRESSION BUT LACK OF PROLIFERATION IN CNS CELLS IN HIVE: EVIDENCE FOR THE ROLE OF CIRCULATING MONOCYTE/MACROPHAGES IN CNS INVASION AND RESERVOIR OF HIV INFECTION Tracy Fischer-Smith, Aderonke Adeniy, Katarzyna Rybicka, Susan Morgello, Kamel Khalili, Jay Rappaport, Sidney E Croul
2:15 – 2:30	175	DIFFERENTIAL GENE EXPRESSION IN AIDS AND HIV ENCEPHALITIS Jorge E Torres-Muñoz, Paul Shapshak, Carol K Petito
2:30 – 2:45	176	IMMUNOCYTOCHEMICAL METHOD FOR THE DIAGNOSIS OF TUBERCULOUS MENINGITIS Vishnampet V Radhakrishnan, Sumi M George, Sheela Reuben, Muraleedharan Nair

3:00 – 3:30 pm REFRESHMENT BREAK

SATURDAY, JUNE 26, 2004

Grand Ballroom A

3:30 pm – 5:15 pm

Platform Session 22: Degenerative IV: Model Systems

Chairpersons: Brent Clark, Mark Forman

3:30 – 3:45	177	COGNITIVE IMPAIRMENT IN TRANSGENIC MICE WITH ABNORMAL INTRANEURONAL TAU PHOSPHORYLATION, BUT LITTLE SILVER POSITIVE NEUROFIBRILLARY PATHOLOGY Karen S SantaCruz, Jada Lewis, Jennifer Paulson, Martin Ingelsson, Linda Kotilinek, Colleen Forster, Aaron Guimaraes, Ami Mariash, Bradley T Hyman, Mike Hutton, Karen H Ashe
3:45 – 4:00	178	ACUTE BUT NOT LONG-TERM ESTRADIOL REPLACEMENT INCREASES BRAIN APOLIPOPROTEIN E AND SYNAPTOPHYSIN IN OVARIETOMIZED MICE Robert G Struble, Craig Cady, Lindsay Jackson, Shari Randall, Jennifer Li, Britto Nathan, Mary McAsey
4:00 – 4:15	179	TRANSGENIC MOUSE MODELS OF TAU PATHOLOGY IN ASTROCYTES LEADING TO NERVOUS SYSTEM DEGENERATION Mark S Forman, Devika Lal, Bin Zhang, Deepa Dabir, Virginia M-Y Lee, John Q Trojanowski,
4:15 – 4:30	180	OVEREXPRESSION OF UNTRANSLATED LIGHT NEUROFILAMENT (NF-L) RNA REPRODUCES THE NEURODEGENERATIVE CHANGES OF MOTOR NEURON DISEASE: IMPLICATIONS OF RNA-BINDING PROTEIN IN THE PATHOGENESIS OF NEURODEGENERATION William W Schlaepfer, Hong Lin, Jinbin Zhai, Rafaela Canete-Soler

4:30 – 4:45	181	REVERSIBILITY OF PURKINJE CELL PATHOLOGY AND ATAXIC BEHAVIOR IN A TETRACYCLINE-RESPONSIVE TRANSGENIC MODEL OF SPINOCEREBELLAR ATAXIA TYPE 1 (SCA1) Tao Zu, Harry T Orr, H Brent Clark
-------------	-----	---------------------------------------------------------------------------------------------------------------------------------------------------------------------------------------

SATURDAY, JUNE 26, 2004

Grand Ballroom B

3:30 pm – 5:15 pm

Platform Session 23: Development/Pediatric II

Chairpersons: Dimitri Agamanolis, Robert Hevner

3:30 – 3:45	182	MARKERS OF OXIDATIVE AND NITRATIVE INJURY ARE INCREASED IN THE CEREBRAL CORTEX OVERLYING PERIVENTRICULAR LEUKOMALACIA (PVL) Yaman Eksioglu, Robin L Haynes, Hannah C Kinney, Felicia Trachtenberg, Joseph J Volpe, Rebecca D Folkert,
3:45 – 4:00	183	NEURAL STEM CELL REDUCTION IN THE VENTRICULAR ZONE OF PERINATAL INJURED BRAINS Kimiko Deguchi, Bobbie Antalffy, Dawna D Armstrong
4:00 – 4:15	184	SUBCLINICAL CARDIORESPIRATORY DYSFUNCTION IN SUDDEN INFANT DEATH SYNDROME ASSOCIATED WITH SEROTONERGIC BRAINSTEM ABNORMALITIES: A CASE REPORT Richard A Belliveau, William P Fifer, Michael M Myers, Leslie L Randall, Felicia Trachtenberg, Hannah C Kinney
4:15 – 4:30	185	SEIZURES, CEREBRAL EDEMA AND HIPPOCAMPAL ANOMALIES IN SUDDEN UNEXPLAINED DEATH IN CHILDREN (SUDC): REPORT OF A SERIES Hannah C Kinney, Dawna L Armstrong, Amy E Chadwick, Laura Crandall, Chelsea Hilbert, Henry Krous
4:30 – 4:45	186	OBSERVATIONS ON THE VASCULAR PATHOLOGY OF MESIAL TEMPORAL LOBE EPILEPSY Venkat R Challa, Dixon M Moody, William R Brown, Clara R Thore, John A Anstrom, Stephen S Glazier
4:45 – 5:00	187	CLINICOPATHOLOGIC FINDINGS IN MESIAL TEMPORAL SCLEROSIS TREATED WITH GAMMA KNIFE RADIOTHERAPY Brian J Yoder, Richard A Prayson
5:00 – 5:15	188	ARRAY-BASED COMPARATIVE GENOMIC HYBRIDIZATION IN CORTICAL DYSPLASIA AND GANGLIOGLIOMAS Bo Xu, Raymond R Tubbs, Gene H Barnett, Richard A Prayson

5:30 – 6:00 pm SPECIAL LECTURE (Grand Ballroom A)

Neuropathology of Musicians, Part II

Lucy B. Rorke, MD

8:00 – 11:00 pm DIAGNOSTIC SLIDE SESSION (Grand Ballroom)

AUTHOR INDEX

- Abbott, RD, 102
 Abel, TW, 28, 129
 Abounader, R, 13
 Adeniran, AJ, 145
 Adeniy, A, 174
 Adesina, AM, 133
 Agamanolis, DP, 73
 Agatic, N, 24
 Al-Sarraj, ST, 98
 Amengual, MA, 268
 Ameriso, S, 154
 An, J, 13
 An, SF, 21, 23
 Andreoletti, O, 19
 Andrew, ME, 102
 Anstrom, JA, 186
 Antalffy, B, 183
 Arena, E, 119
 Arismendi, GJ, 94, 151
 Armstrong, DD, 183
 Armstrong, DL, 185
 Arrigain, S, 12
 Ashe, KH, 177
 Atwood, CS, 44, 45
 Bacskai, BJ, 6
 Baglin, C, 96
 Bagri, A, 111
 Bai, H, 20
 Bajenaru, L, 36
 Baker, SJ, 129
 Baldwin, DA, 42
 Banerjee, A, 105
 Bannykh, SI, 8
 Barnard, JJ, 83
 Barnett, GH, 12, 136
 Basset-Leobon, C, 19
 Bastian, FO, 67
 Bataillard, M, 7
 Bazille, C, 96
 Beach, TG, 169
 Becher, MW, 26
 Beckner, ME, 13, 35
 Begue, C, 68
 Belliveau, RA, 184
 Benner, A, 11
 Bennett, DA, 172
 Bensimhon, D, 96
 Bhatt, YM, 106
 Bhattacharjee, MB, 108, 133
 Biegel, JA, 33
 Bigio, EH, 50
 Blaschke, B, 9
 Boardman, CL, 120
 Boczkowski, J, 154
 Bollen, AW, 32, 111
 Bondar, JV, 12
 Borchelt, D, 46
 Bornemann, A, 27
 Bouffard, J, 53
 Bowen, JD, 156
 Bowen, RL, 44, 45
 Boyer, PJ, 25, 83, 155, 160
 Brat, DJ, 4, 15
 Britton, CB, 81
 Broadus, WC, 103
 Brown, CA, 89
 Brown, D, 61
 Brown, WR, 186
 Brucklacher, RM, 80
 Brush, JW, 3
 Buckleair, L, 140
 Bugiani, O, 17, 70
 Bundock, EA, 106
 Burack, R, 34
 Burchfiel, CM, 102
 Burckhard, C, 10
 Burger, PC, 28, 33, 110, 111, 120, 129, 165
 Burns, DK, 25, 83, 128
 Burovic, F, 13
 Byrne, NP, 110
 Cady, C, 178
 Camelo, S, 1
 Campbell, KP, 36, 89
 Campbell, W, 3
 Campos, J, 68
 Canete-Soler, R, 180
 Cantin, L, 112
 Capobianco, R, 17
 Capranico, G, 124
 Cardona, AE, 49, 60
 Cardozo, DP, 94, 151
 Cardozo, JJ, 94, 151
 Carroll, SL, 30
 Carsana, L, 17
 Carter, SC, 172
 Casadesus, G, 44, 45
 Casado, A, 116, 115
 Castellani, RJ, 44, 56
 Castellano-Sanchez, AA, 73
 Ceccarelli, C, 124
 Cenacchi, G, 100, 124
 Chadwick, AE, 185
 Challa, VR, 186
 Chan, C, 123
 Chandan, VS, 141
 Chang, HT, 86, 104, 109, 141
 Chaudhry, A, 28
 Chen, K, 20
 Chen, SG, 20
 Chen, X, 13
 Cheng, L, 148, 149
 Chernova, OB, 118
 Chiriboga, L, 14
 Chu, A, 138
 Chung, W, 76
 Cisneros, R, 169
 Clark, HB, 181
 Clarke, LE, 83
 Clever, JL, 18
 Clifford, S, 29
 Cochran, EJ, 69, 160
 Cohen, ML, 161
 Colvin, GA, 39
 Commane, M, 118
 Common, R, 56
 Conant, K, 46
 Conti, A, 100
 Cook, D, 60
 Coons, SW, 74, 150
 Couce, ME, 82
 Crandall, L, 185
 Crary, JF, 52
 Cras, P, 16, 61
 Croul, SE, 174
 Crum, B, 152
 Sullum, C Munro, 59
 Dabir, D, 179
 Dalton, J, 126, 167
 Dangond, F, 1
 Daou, M, 117
 Daroca, P, 108
 Darras, B, 95
 Dash, S, 67
 David, O, 108
 Day, BW, 13
 De Girolami, U, 95, 135
 De Waele, M, 16
 DeArmond, SJ, 18
 Dedhar, S, 37
 DeGirolami, U, 1
 Deguchi, K, 183
 Del Vecchio, M, 100
 Del Villar, K, 170
 Delisle, M, 19
 Deng, H, 20
 Derenzini, M, 124
 Deshpande, CG, 127
 Dessen, P, 10
 Devi, SN, 15
 Di Fede, G, 17
 Di Patre, P, 10
 Dickerson, BC, 93
 Dickson, DW, 57, 58, 157
 Diesta, C, 81
 Dilys, P, 146
 Dlouhy, SR, 70, 72
 Dobbeleir, I, 16
 Dodson, SE, 172
 Domnitz, SB, 6
 Donahue, JE, 123, 171
 Dong, S, 101
 Dong, Z, 166
 Dooner, MS, 39
 Dubowy, R, 109
 Due, B, 1
 Duncan, JA, 171
 Duran, G, 1

Eaton, MJ, 3
 Eberhart, CG, 28, 129
 Ebert, B, 81
 Ehrich, M, 24
 Eksioglu, Y, 182
 Ellison, D, 29
 Epperson, F, 70, 72
 Ervin, JF, 71
 Fallon, B, 81
 Farlow, MR, 70, 72, 160
 Feiz-Erfan, I, 150
 Fekedulegn, D, 102
 Feldman, H, 66
 Fenichel, GM, 89
 Fernandez-Abreu, MC, 151
 Ferracini, R, 100
 Ferrante, RJ, 1
 Fiaño, C, 115, 116
 Fifer, WP, 184
 Finkelstein, SD, 35, 161, 163, 164
 Fischer-Smith, T, 174
 Fociani, P, 17
 Folkerth, RD, 106, 182
 Forman, MS, 159, 179
 Forster, C, 177
 Fortino, AE, 56
 Fouladi, M, 126, 167
 Frantzen, L, 50
 Fraser, J, 61
 Fraser, M, 129
 Fritz, P, 88
 Frosch, MP, 1, 6
 Fujino, Y, 58
 Fukuda, T, 64
 Fuller, CE, 125, 126, 167
 Fung, K, 127
 Gabrielle, d, 145
 Gajjar, A, 126
 Galindo, RL, 83
 Galloway, M, 142
 Gambetti, P, 20
 Garcia, CA, 108
 Gardner, P, 82
 Garrido, S, 154
 Garry, RF, 67
 Gearing, M, 70, 172
 Gelman, BB, 173
 George, DH, 165
 George, SM, 176
 Germin, BI, 97
 Ghatak, NR, 103
 Ghetti, B, 56, 69, 70, 72, 155, 160
 Giaccone, G, 17, 70
 Giangaspero, F, 124
 Giannini, C, 34, 152
 Glazier, SS, 186
 Goebel, HH, 88, 90
 Goedert, M, 69
 Goicochea, MT, 68
 Golabek, AA, 41
 Golden, J, 38
 Goldfarb, LG, 88
 Goldman, JE, 81
 Goldthwaite, PT, 110
 Golubic, M, 12
 Gomyoda, M, 158
 Goodman, JC, 133
 Gould, PV, 112
 Goumnerova, LC, 106, 135
 Gray, F, 96
 Gray, SG, 1
 Greenberg, SM, 6
 Griggs, RC, 89
 Groves, MJ, 23
 Guimaraes, A, 177
 Gumerlock, MK, 127
 Gupta, N, 105
 Guthikonda, B, 140
 Gutierrez, C, 139
 Gutmann, DH, 31, 36
 Haddix, T, 143
 Hafez, N, 103
 Hahn, M, 11
 Hahn, S, 109
 Halim, N, 43
 Hamilton, RL, 33, 35, 82
 Hancock, S, 24
 Handisurya, A, 46
 Hargrave, KR, 155
 Harris, PL, 48, 51
 Hasegawa, M, 79
 Hasizume, Y, 158
 Hatanpaa, KJ, 128
 Hattab, EM, 148, 149
 Havens, J, 125
 Hayashi, H, 63
 Haynes, RL, 182
 He, TT, 49
 Hedley-Whyte, ET, 93
 Hedreen, JC, 65
 Heffron, DS, 5
 Helton, K, 126, 167
 Herman, MM, 43
 Hernandez-Moneo, JL, 115, 116
 Hilbert, C, 185
 Hillaire, C, 46
 Hinckley, J, 24
 Hinojoza, JR, 3
 Hladik, CL, 59, 128, 153
 Hochberg, FH, 93
 Honda, K, 48
 Horstmann, S, 10
 Hortobagyi, T, 98
 Housman, C, 80
 Hovanesian, V, 171
 Huang, D, 49, 60
 Huang, EJ, 18
 Huang, S, 20
 Hui, S, 72
 Hulette, CM, 71
 Hutchison, RE, 141
 Hutton, M, 177
 Hwang, D, 1
 Hyde, TM, 43
 Hyman, BT, 177
 Hynan, LS, 59
 Iannaccone, ST, 25
 Iglesias, AH, 1
 Imitola, J, 1
 Ingelsson, M, 177
 Ishida, G, 158
 Ishikawa, K, 158
 Ishikura, N, 18
 Jackson, L, 178
 Jacques, TS, 142
 Jasmin, L, 32
 Jean-Jacques, H, 19
 Jenkins, JJ, 125
 Jenkins, R, 120
 Jenny, AL, 20
 Jeon, YK, 137
 Johanson, CE, 171
 Johnson, NA, 50
 Jones, KM, 86
 Jortner, BS, 24
 Joseph, JM, 25
 Jourde, B, 10
 Judkins, AR, 33, 78, 138, 159
 Jung, S, 60
 Kadire, J, 15
 Kaimaktchiev, V, 90
 Kalasinsky, VF, 91
 Kalkanis, SN, 130
 Kamiya, H, 87
 Kanter, D, 145
 Kashima, K, 79
 Kato, S, 63
 Katsuse, O, 57, 157
 Kawakami, E, 63
 Kearns, S, 122
 Kerrigan, JF, 74
 Khalili, K, 174
 Khemani, P, 25
 Khoury, SJ, 1
 Kida, E, 41
 Kidd, G, 49, 60
 Kiehl, T, 130
 Kieu, J, 3
 Kim, H, 76, 77
 Kim, J, 8, 76, 77
 Kim, M, 76, 77
 Kim, Y, 76
 Kinney, HC, 182, 184, 185
 Kirnbauer, R, 46
 Kish, J, 49
 Kissel, JT, 89
 Kleihues, P, 10
 Kleinman, JE, 43
 Kleinschmidt-DeMasters, BK, 31, 33
 Klement, IA, 75
 Klocke, BJ, 40
 Knobbe, C, 9
 Kong, Q, 20

- Korshunov, A, 11
Kotilinek, L, 177
Koto, A, 160
Kraybill, M, 156
Krous, H, 185
Kukull, WA, 156
Kun, L, 167
Kuo, L, 21, 23
Kurtkaya, O, 31
Lacerte, D, 112
Lah, JJ, 172
Laing, N, 90
Lal, D, 179
Lamont, J, 29
Landas, SK, 104
Langley, B, 1
Laningham, F, 125
Laplanche, J, 19
Larson, EB, 156
Lattera, J, 13
Latorre, JG, 109
Laule, C, 2
Lear-Kaul, K, 153
Lee, C, 21, 23
Lee, H, 47
Lee, JM, 168
Lee, M, 76, 77
Lee, VM, 65, 179
Leung, E, 2
Leverenz, JB, 156
Levey, AI, 172
Lewin-Smith, MR, 91
Lewis, J, 177
Lewis, M, 4
Li, DK, 2
Li, J, 178
Li, Q, 114
Li, Z, 62
Libien, J, 81
Lichter, P, 11
Liegner, KB, 81
Ligon, KL, 135
Limido, L, 17
Lin, H, 180
Lin, W, 57
Lipska, BK, 43
Lira, S, 60
Littman, DR, 60
Liu, Q, 51
Lommes, P, 8
Lopes, MBS, 84
Louis, DN, 101, 130
Lubieniecki, F, 92
Maccioni, RB, 51
Maciunas, R, 161
MacKay, AL, 2
Mackenzie, IR, 66
Madory, JE, 147
Mandel, R, 122
Mandell, JW, 5
Manes, F, 68
Mangieri, M, 17
Mankodi, A, 26
Margeta, M, 32
Mariash, A, 177
Martin, J, 16
Martinetto, HE, 68
Martinez, D, 159
Martinez, P, 115, 116
Mascha, EJ, 12
Mathews, KD, 89
McAsey, M, 178
McClintock, BW, 43
McCormick, WC, 156
McDermott, ME, 67
McFadden, KA, 82
McLaurin, A, 71
McLendon, RE, 113, 163, 164
McManamy, C, 29
McManus, M, 38
Meggan, M, 49
Melendez, B, 115, 116
Mena, H, 53, 91
Mendell, JR, 89
Mendrinis, SE, 4
Messing, A, 36
Mesulam, MM, 50
Michele, DE, 89
Mikol, J, 96
Miller, BB, 84
Miller, CA, 170
Miller, DC, 119, 162
Miravalle, L, 70, 72, 160
Mirra, SS, 52, 54, 70
Mizusawa, H, 158
Mizutani, T, 63
Mokri, B, 152
Mollejo, M, 115, 116
Montalvo, C, 139
Montine, TJ, 156
Moody, DM, 186
Moore, BE, 39
Moore, GRW, 2
Moore, SA, 36, 89
Mora, E, 94
Morgello, S, 174
Morita, T, 63
Moritani, T, 97
Moroz, AL, 91
Motoyoshi, Y, 79
Mott, RT, 113
Mourelatos, Z, 42
Mufson, EJ, 172
Mullick, FG, 91
Murakata, LA, 91
Murayama, S, 79
Murrell, JR, 69, 70, 72, 155, 160
Myers, MM, 184
Naarden, AL, 25
Nair, M, 176
Nakano, I, 79
Narus, M, 90
Nasrallah, I, 38
Nathan, B, 178
Nathoo, N, 12, 118
Neben, K, 11
Nelson, JS, 102
Nelson, PT, 42
Newcomb, EW, 14, 119
Newell, A, 169
Ng, H, 166
Ng, Y, 74
Niewmierzycza, A, 37
Nishikawa, T, 10
Nixon, R, 90
Nochlin, D, 156
Nolen, JDL, 4
Nowoslawski, L, 40
Nunomura, A, 48
Nutt, CL, 101
Nägele, A, 88
Oberholtzer, JC, 42
Oblinger, JL, 120
Offe, K, 172
Ogawa, O, 45
Ohara, PT, 32
Ohgaki, H, 10
Omalu, BI, 55, 99
Omrán, OM, 121
O'Neill, BP, 34
O'Neill, MJ, 47
O'Rourke, K, 20
Orr, HT, 181
Owada, K, 158
Oyanagi, K, 63
Palmini, A, 77
Pancoast, M, 38
Pandya, Y, 169
Pang, JC, 166
Panigazzi, AL, 92
Pappolla, MA, 44, 45
Park, S, 137
Parodi, JC, 154
Pate, L, 105
Paty, DW, 2
Paulson, J, 177
Paulus, W, 134
Pearl, DK, 120
Pearson, A, 29
Pecot, M, 15
Pena, JA, 94
Peoc'h, K, 19
Perkins, T, 72
Perry, A, 8, 31, 33, 34, 127, 165
Perry, G, 44, 45, 47, 48, 51, 56
Pestronk, A, 89
Petito, CK, 175
Petropoulou, KG, 127
Picard, C, 112
Piccardo, P, 70, 72, 155, 160
Pierson, CR, 22, 95, 135
Pollack, IF, 13, 35
Polymeropoulos, MH, 69

Pomeroy, S, 33
 Poon, W, 166
 Poston, M, 169
 Potter, P, 169
 Powell, SZ, 133, 139, 140
 Powers, JM, 97
 Prayson, RA, 12, 31, 136, 187, 188
 Prichard, J, 143
 Prior, TW, 120
 Puttmann-Cyrus, S, 134
 Qian, J, 114
 Quesenberry, PJ, 39
 Quezado, M, 146
 Quinones-Hinajosa, A, 107
 Quinton, RA, 83
 Rademaker, AW, 50
 Radhakrishnan, VV, 176
 Raffel, JM, 107
 Raghavan, R, 131
 Raina, AK, 44
 Raisanen, J, 128
 Rakheja, D, 128
 Randall, LL, 184
 Randall, S, 178
 Ransohoff, RM, 49, 60
 Rappaport, J, 174
 Ratan, RR, 1
 Rebeck, GW, 6
 Reichard, R, 153
 Reichardt, LF, 37
 Reifenberger, G, 9
 Reifenberger, J, 9
 Rekate, HL, 74
 Reuben, S, 176
 Ribalta, T, 115, 116
 Richkind, K, 135
 Rigal, M, 19
 Riudavets, MA, 53
 Robbins, EM, 6
 Rodriguez, FJ, 152
 Rojiani, AM, 144
 Rojiani, MV, 144
 Rolston, RK, 161
 Romero, NB, 92
 Rong, Y, 15
 Rorke, LB, 33
 Rosenblum, MK, 33
 Ross, AH, 117
 Ross, JS, 114
 Ross-Barta, SE, 36
 Roth, KA, 40
 Roy, S, 85, 78, 138
 Rozin, L, 55
 Ruano, Y, 115, 116
 Ruchoux, M, 7
 Rudow, G, 46
 Rushing, EJ, 53, 146
 Russo, A, 124
 Rybicka, K, 174
 Saad, AG, 145
 Saccoliti, M, 92
 Sacktor, TC, 52
 Sagar, S, 161
 Sager, KL, 172
 Saito, F, 36
 Saito, Y, 79
 Sakurai, N, 158
 Salaroli, R, 124
 Salceies, KM, 26
 Samayoa, E, 18
 Sandberg, GD, 53
 Sanford, RA, 125, 126
 SantaCruz, KS, 177
 Santi, M, 146
 Saqr, HE, 121
 Sarchi, MI, 154
 Sasatomi, E, 35
 Sasse, ME, 60
 Sayre, LM, 51
 Scaravilli, F, 21, 23, 142
 Scheffler, B, 122
 Scheithauer, BW, 31, 120, 152
 Schelper, RL, 104, 109, 141
 Schlaepfer, WW, 180
 Schmechel, DE, 71
 Schuenke, K, 173
 Schultz, M, 68
 Scott, K, 155
 Sechtem, U, 88
 Sevlever, G, 68, 154
 Shakir, A, 55
 Shannon, KM, 69
 Shao, CY, 52
 Shapshak, P, 175
 Sharma, S, 128
 Shaw, P, 50
 Sheehan, CE, 114
 Sheffield, LG, 54
 Shehata, B, 73
 Shilling, CJ, 89
 Shimomura, NI, 79
 Shrimpton, AE, 141
 Siedlak, SL, 51, 48
 Silverberg, GD, 171
 Sima, AA, 22, 62, 87
 Smith, MA, 44, 45, 47, 48, 51, 56
 Smith, ML, 78
 Smith, MT, 132, 147
 Smith, TW, 117
 Snyder, J, 54
 Sobel, RA, 3
 Soukup, VM, 173
 Specht, CS, 91
 Spies-Swain, R, 110
 St-Arnaud, R, 37
 Staugaitis, SM, 118
 Stearns, D, 28
 Stein, EJ, 49
 Steindler, D, 122
 Stemmer-Rachamimov, AO, 101
 Stephanopoulos, G, 1
 Stevens, G, 118
 Stolle, C, 89
 Stonecypher, MS, 30
 Stopa, EG, 123, 171
 Straub, RE, 43
 Struble, RG, 178
 Stéphane, H, 19
 Suardi, S, 17
 Sue, LI, 169
 Suh, J, 12
 Suh, Y, 137
 Sullivan, S, 122
 Sutton, LL, 78
 Suzuki, K, 64
 Swalsky, PA, 35, 161, 163, 164
 Sy, M, 20
 Syed, S, 131
 Tagliavini, F, 17, 70
 Takahashi, H, 63
 Takao, M, 160
 Takikita, S, 64
 Tang, AA, 18
 Tani, M, 49
 Taratuto, AL, 68, 92
 Tavares, R, 123, 171
 Teri, L, 156
 Thore, CR, 186
 Thornton, C, 26
 Tian, D, 93
 Tihan, T, 105, 107, 110, 111, 129
 Timmons, CF, 128
 Tlomak, W, 26
 Toda, T, 79
 Torres-Muñoz, JE, 175
 Toru, S, 158
 Toscas, I, 115, 116
 Toussaint, N, 122
 Towfighi, J, 80, 83, 155, 160
 Trabousee, A, 2
 Trachtenberg, F, 182, 184
 Trojanowski, JQ, 65, 159, 179
 Troncoso, JC, 46
 Tsuang, DW, 156
 Tsuboi, Y, 58
 Tu, P, 34, 148, 149
 Tubbs, RR, 188
 Turmel, A, 112
 Turner, KC, 113
 Uro-Coste, E, 19
 Van Everbroeck, B, 16, 61
 Van Meir, EG, 15
 Vance, J, 71
 Vanegas, D, 20
 Vannucci, RC, 80
 Vargo, L, 12
 Varma, A, 118
 Vidal, R, 160
 Vilchez, GJ, 151
 Villamil, AR, 154
 Vinters, HV, 75
 Visvesvara, GS, 82
 Vogel, H, 143

28

Vogelbaum, MA, 118
Volpe, JJ, 182
Véronique, S, 19
Wada, M, 63
Wagner, K, 145
Wall, C, 89
Walsh, J, 108
Walsh, RJ, 93
Walus, M, 41
Wang, C, 21
Wang, M, 20
Warnke, R, 143
Watabe, K, 63
Webber, KM, 44, 45
Wecht, CH, 55
Weeks, D, 90
Wegner, M, 8
Weickert, CS, 43
Weinberger, DR, 43
Weiner, MF, 59
Weintraub, S, 50
Welsh, CT, 132, 147
Westra, S, 36, 89
White, CL, 59, 83, 128, 153
White, WL, 150
Wicklund, MP, 89
Williams, C, 170
Williams, L, 24
Wilson, JD, 148, 149
Wise, S, 98
Wisniewski, KE, 41
Wolfe, GI, 25
Wolfe, J, 145
Womack, KB, 59
Woo, Y, 76, 77
Wrobel, G, 11
Wu, D, 20
Wu, Q, 123
Wujek, J, 49
Wynshaw-Boris, A, 38
Xin, W, 95
Xu, B, 188
Yachnis, AT, 33, 34, 122
Yagi, T, 64
Yamaguchi, K, 69, 70, 72
Yamazaki, M, 63
Yang, X, 114
Yates, AJ, 120, 121
Yee, H, 14
Yoder, BJ, 136, 187
Yoshida, M, 158
Yoshor, D, 140
Zagzag, D, 14, 119
Zamora, ED, 46
Zedda, C, 154
Zhai, J, 180
Zhang, B, 179
Zhang, PJ, 85, 138
Zhang, W, 22
Zhao, G, 2
Zhou, L, 166

Zhou, Z, 27
Zhu, X, 47
Zhukareva, V, 65
Zou, W, 20
Zu, T, 181